

DATE: 4/2/2020 10:10:23 AM

FILE: pw:\us-hou-pw01.dannenbaum.local:Dannenbaum\Documents\Transportation\4946-04\Project Documentation\Submittals\Final\4946_FM468_CROSS_SECTION_SHEETS.dgn

CHK: DWG: SHEETS.dgn

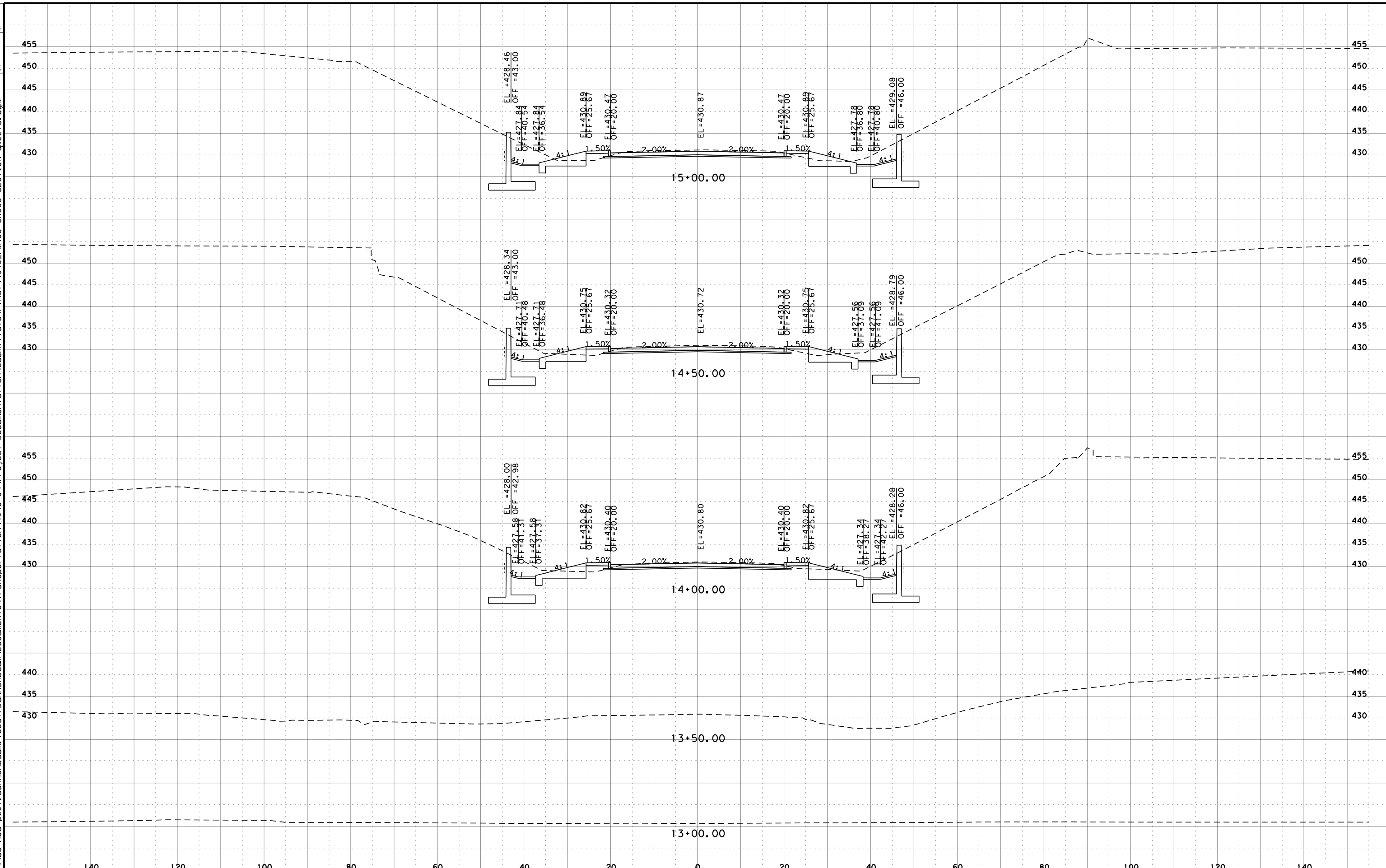

FM 468 CROSS SECTIONS

FOR INFORMATION PURPOSES ONLY
 CROSS SECTION DATA IS FOR NON-CONSTRUCTION
 PURPOSES ONLY. IT IS THE RESPONSIBILITY OF
 THE PROSPECTIVE BIDDER TO VALIDATE THE DATA.

SCALE: 1" = 20 (HORZ)
 1" = 20 (VERT)
 SHEET 1 OF 2

DANNENBAUM
 ENGINEERING COMPANY-DALLAS, LLC
 T.B.P.E. FIRM REGISTRATION #8996
 3030 LBJ FREEWAY, SUITE 910 DALLAS, TX 75234 (972)239-2002



CONT	SECT	JOB	HIGHWAY
\$C\$	\$S\$	\$J\$	\$HWY\$
DIST	COUNTY	SHEET NO.	
\$DST\$	\$CTY\$	1	

DATE: 4/27/2020 10:10:25 AM
 FILE: \\us-hou-pw01.dannenbaum.local\Documents\Transportation\4946-04\Project Documentation\Submittals\Final\4946_FM468_CROSS_SECTION_SHEETS.dgn

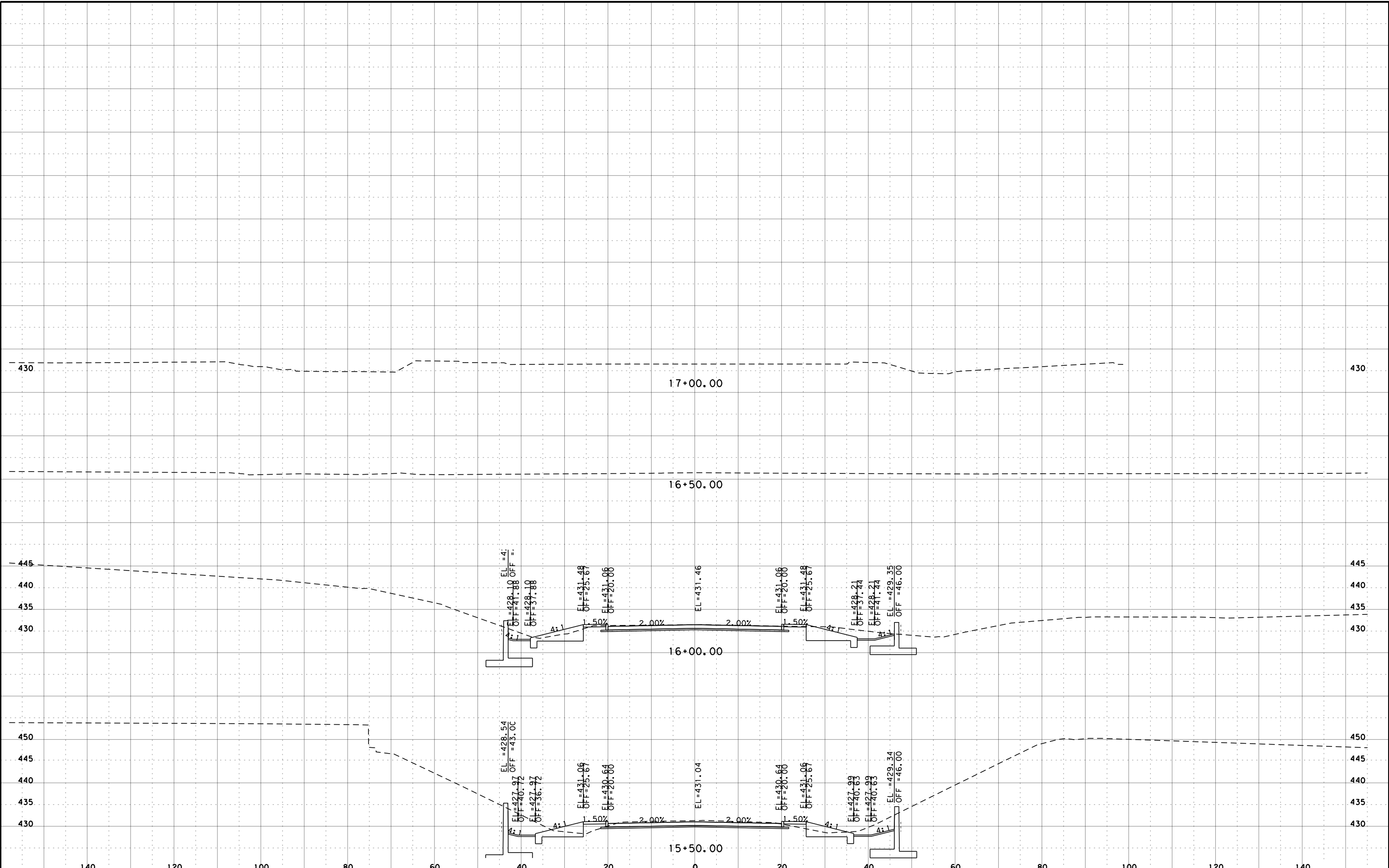

FM 468 CROSS SECTIONS

FOR INFORMATION PURPOSES ONLY
 CROSS SECTION DATA IS FOR NON-CONSTRUCTION PURPOSES ONLY. IT IS THE RESPONSIBILITY OF THE PROSPECTIVE BIDDER TO VALIDATE THE DATA.

SCALE: 1" = 20 (HORZ)
 1" = 20 (VERT)
 SHEET 2 OF 2

DANNENBAUM
 ENGINEERING COMPANY-DALLAS, LLC
 T.B.P.E. FIRM REGISTRATION #8996
 3030 LBJ FREEWAY, SUITE 910 DALLAS, TX 75234 (972)239-2002



CONT	SECT	JOB	HIGHWAY
\$C\$	\$S\$	\$J\$	\$HWY\$
DIST	COUNTY	SHEET NO.	
\$DST\$	\$CTY\$	2	