

2:15:00  
 2008/08/08 10:00 AM  
 I:\Projects\I-635\Drawings\Sheet\I-635-D7.dwg  
 1:1:15:00 10:00 AM 10/10/2008 10:00 AM

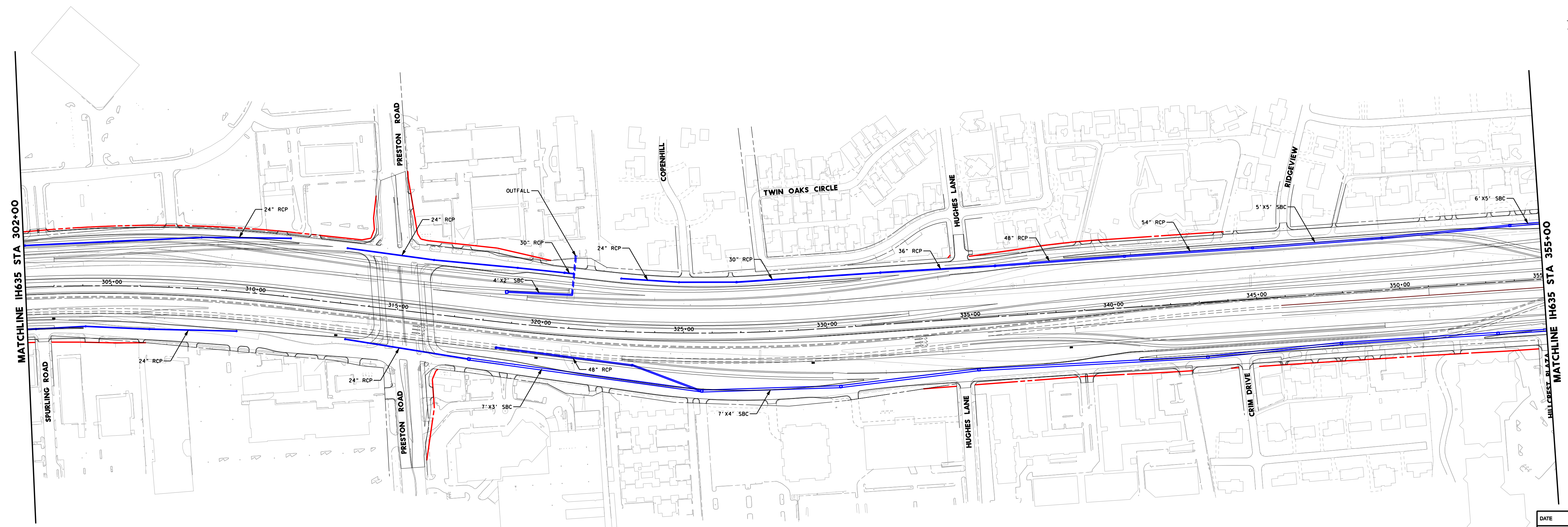

LEGEND	
<span style="color: red;">—</span>	EXISTING DRAINAGE STRUCTURE
<span style="color: blue;">—</span>	PROPOSED DRAINAGE STRUCTURE
<span style="color: black;">—</span>	EXISTING ROW
<span style="color: red;">—</span>	PROPOSED ROW
*	PROPOSED WET/DETENTION PONDS
LINK SIZES NOTED ONLY WHEN CHANGES OCCUR	

THE CONTRACTOR SHALL OBTAIN TEMPORARY CONSTRUCTION EASEMENTS AS NEEDED TO CONSTRUCT HEADWALLS, RIPRAP AND MISCELLANEOUS CONSTRUCTION ITEMS ADJACENT TO THE PROPOSED ROW.

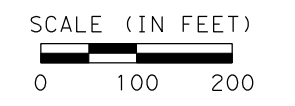

I.H. 635	
DRAINAGE LAYOUT	
SHEET 7 OF 14	Page 94
DATE	05/08/2008
SHEET No.	D7