

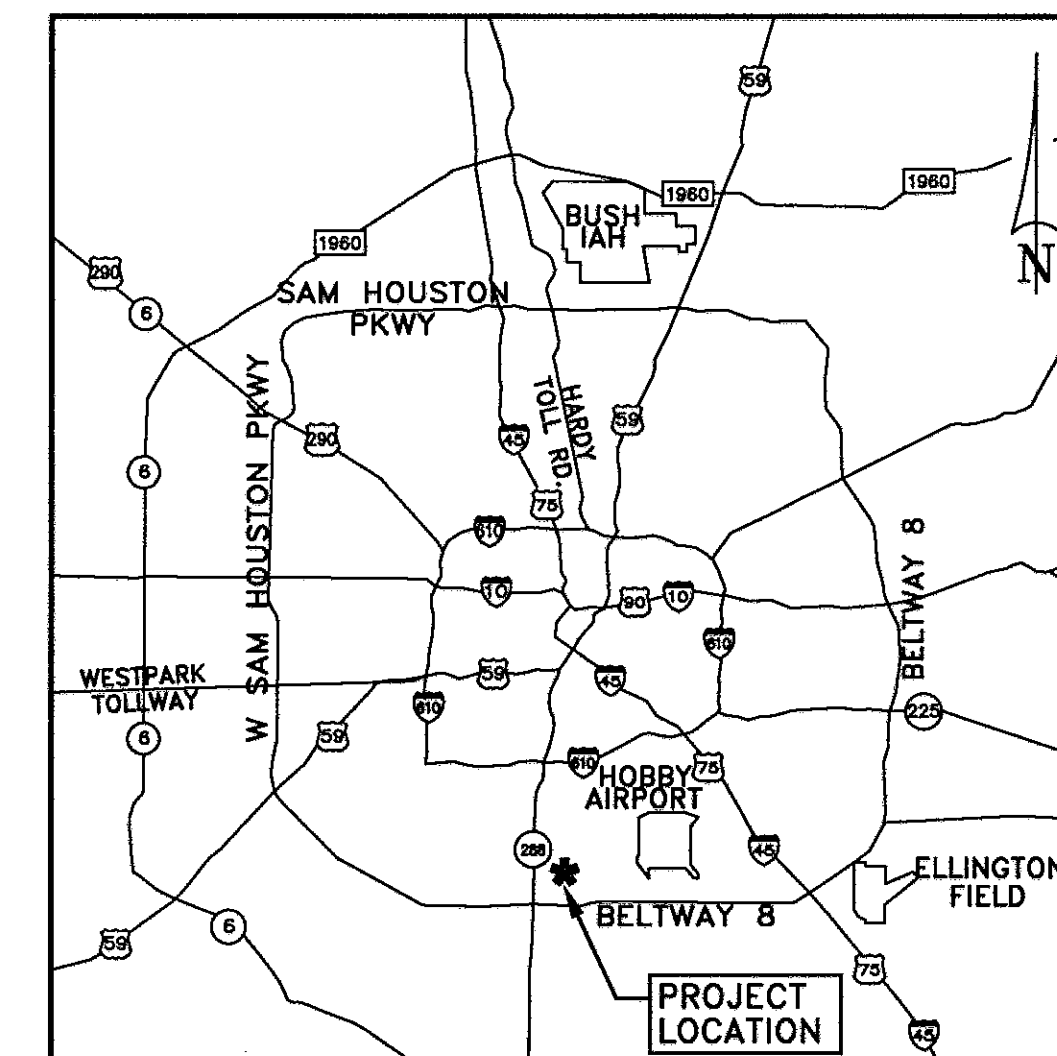

INDEX	
SHEET NO.	DESCRIPTION
A	COVER SHEET
B&C1	GENERAL DETAILS & SPECIFICATIONS
101-103	PLAN & PROFILE SHEETS
D	TRAFFIC CONTROL DETAIL
E	MANHOLE STEEL DETAIL
F	TYPICAL S.W.P. PLAN
R	STREET CUT RESTORATION DETAILS

**HOUSTON SOUTHWEST IDLEWOOD '433' WK-4433**  
**PROP. CONDUIT EXTENSION AT ALMEDA-GENOA FROM EXIST. MH #10832 ON SH 288 ACCESS ROAD**  
**TO FUTURE RT #2020 ON HYCOHEN ROAD FOR APPROXIMATELY 650 LINEAR FEET**



LOCATION MAP

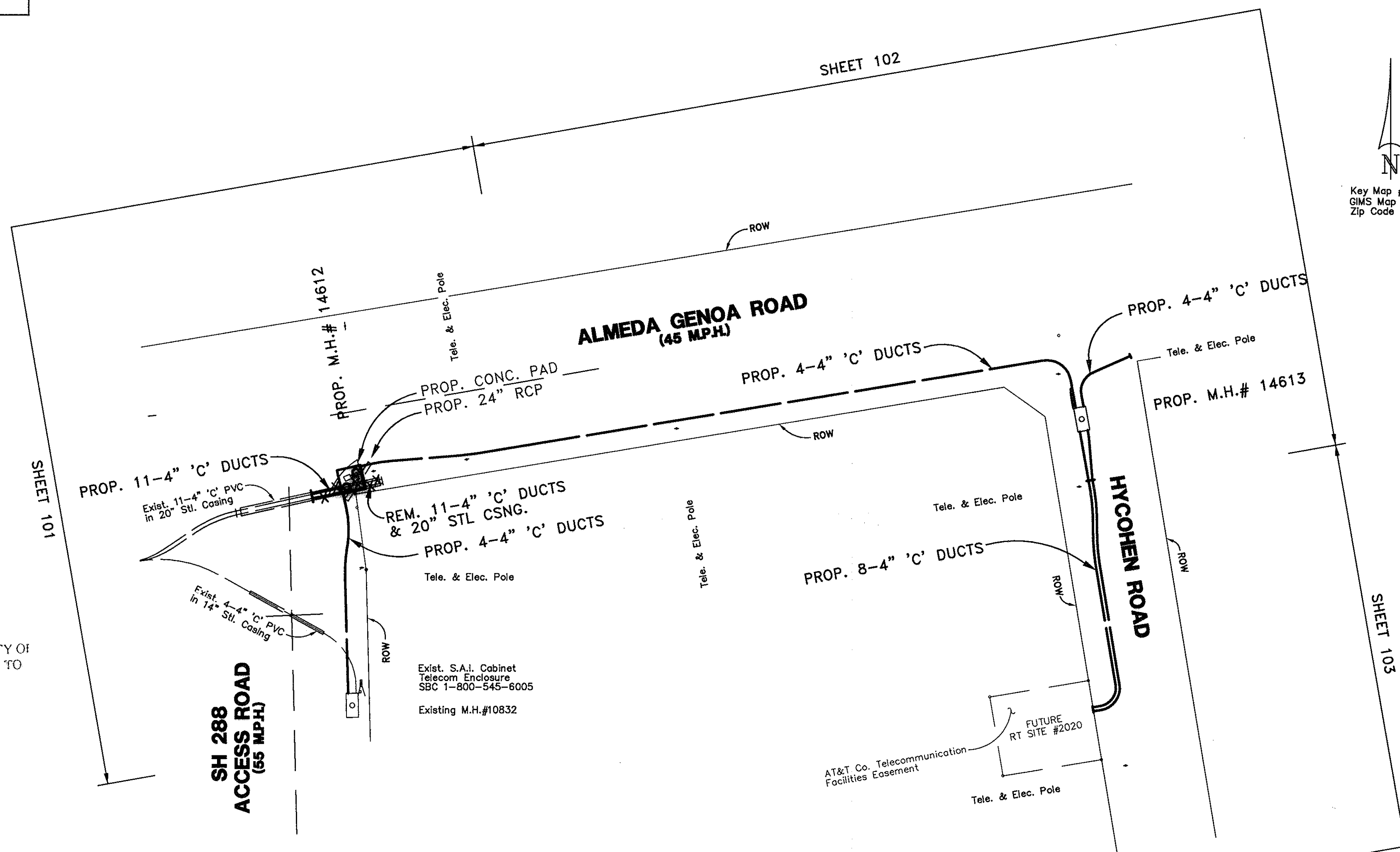

Key Map #573-S  
 GIMS Map #5351D  
 Zip Code #77047

THIS PROJECT INCLUDES WORK TO BE PERFORMED IN THE CITY OF HOUSTON'S RIGHT OF WAY AND MUST BE PERMITTED PRIOR TO CONSTRUCTION. CONTACT THE REQUIRED SECTIONS BELOW AS INDICATED.

**LOCATION-3300 MAIN**  
 PAVING 713 535 7579  
 SANITARY 713 535 7885  
 WATER 713 535 7885  
 STORM 713 535 7579

**LOCATION-SH WALKER**  
 STREET CUT 713 837 0546

**TxDOT PERMIT NO. 06-1043**

NOTE: CITY SIGNATURES VALID FOR ONE YEAR ONLY AFTER DATE OF SIGNATURES

**Cobb Fendley ASSOCIATES**  
 13430 NORTHWEST FWY, SUITE 1100  
 HOUSTON, TEXAS 77040 (713) 462-3242  
 SURVEYED BY: CFA  
 FB NO. 1815

9-13-06  
 MONICA F. SILVER  
 85589  
 LICENSED PROFESSIONAL ENGINEER

**CITY OF HOUSTON**  
 DEPARTMENT OF PUBLIC WORKS AND ENGINEERING

WATER	STREET & SEWER
WASTEWATER	TRAFFIC & TRANSPORTATION
STORM	STORM WATER QUALITY
FACILITIES	

FOR CITY OF HOUSTON USE ONLY  
 CITY DWG. NO. 42399

CITY ENGINEER  
 DIRECTOR OF PUBLIC WORKS AND ENGINEERING

ILMS # 06072433 COH Log No. 2006-1043

Contractor shall comply with City of Houston Street Cut Ordinance.

AREA DETERMINED TO BE OUTSIDE THE 500-YEAR FLOODPLAIN (ZONE-X) BASED ON F.I.R.M. 48201C1010 K - PANEL 1010 OF 1135 (REF. April 20, 2000)

Contractor shall notify the City of Houston, Department of Public Works and Engineering, Engineering Construction Division (Telephone No. 713-863-1450) 48 hours before starting work on this project.

REVISION	REVISION DATE	DESCRIPTION	INITIAL

CP	PROJECT NO.	AREA NO.	DATE ISSUED	NUMBER OF SHEETS	A
		WK-4433		10	

ALMEDA-GENOA @ SH 288 TO HYCOHEN

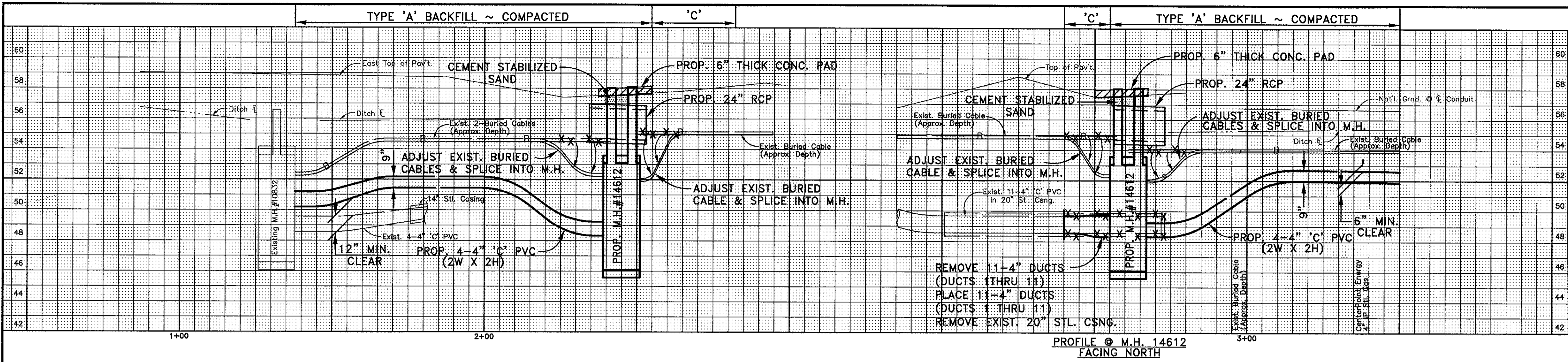

MFR 4C  
 PLAC 1 TO 8  
 OPER. RANGE

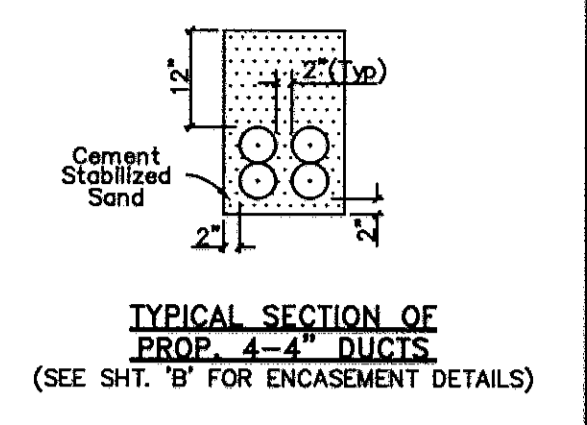

OPER	ACTION CODE	MAJOR MATERIAL DESCRIPTION	ACCT. CODE	ML OR AMT.	PL	BORE	REMOVALS AMOUNT	MORT DATE
1	PLAC	MANHOLE	4C		1			
2	PLAC	TRENCH-4-MPC	4C	101'				
3	PLAC	PVC-4", 4	4C		404'			
4	PLAC	TRENCH-4-MPC	4C	378'				
5	PLAC	PVC-4", 4	4C		1512'			
6	REM	CONDUIT-PVC-11	4X				21'	'06
7	REM	CONDUIT-PVC-11	4M				15'	'06
8	PLAC	PVC-4", 11	4M		165'			

EXIST. MH# 10832 TO PROP. MH# 14612  
 101' W-W, 113' C-C

PROP. MH# 14612 TO PROP. MH# 14613 (SHEET 102)  
 378' W-W, 390' C-C

NOTE: CONTRACTOR TO MAINTAIN ACCESS TO ADJACENT PROPERTIES AT ALL TIMES.

SEE CONSTRUCTION NOTES & DETAILS ON B, C & D SHEETS

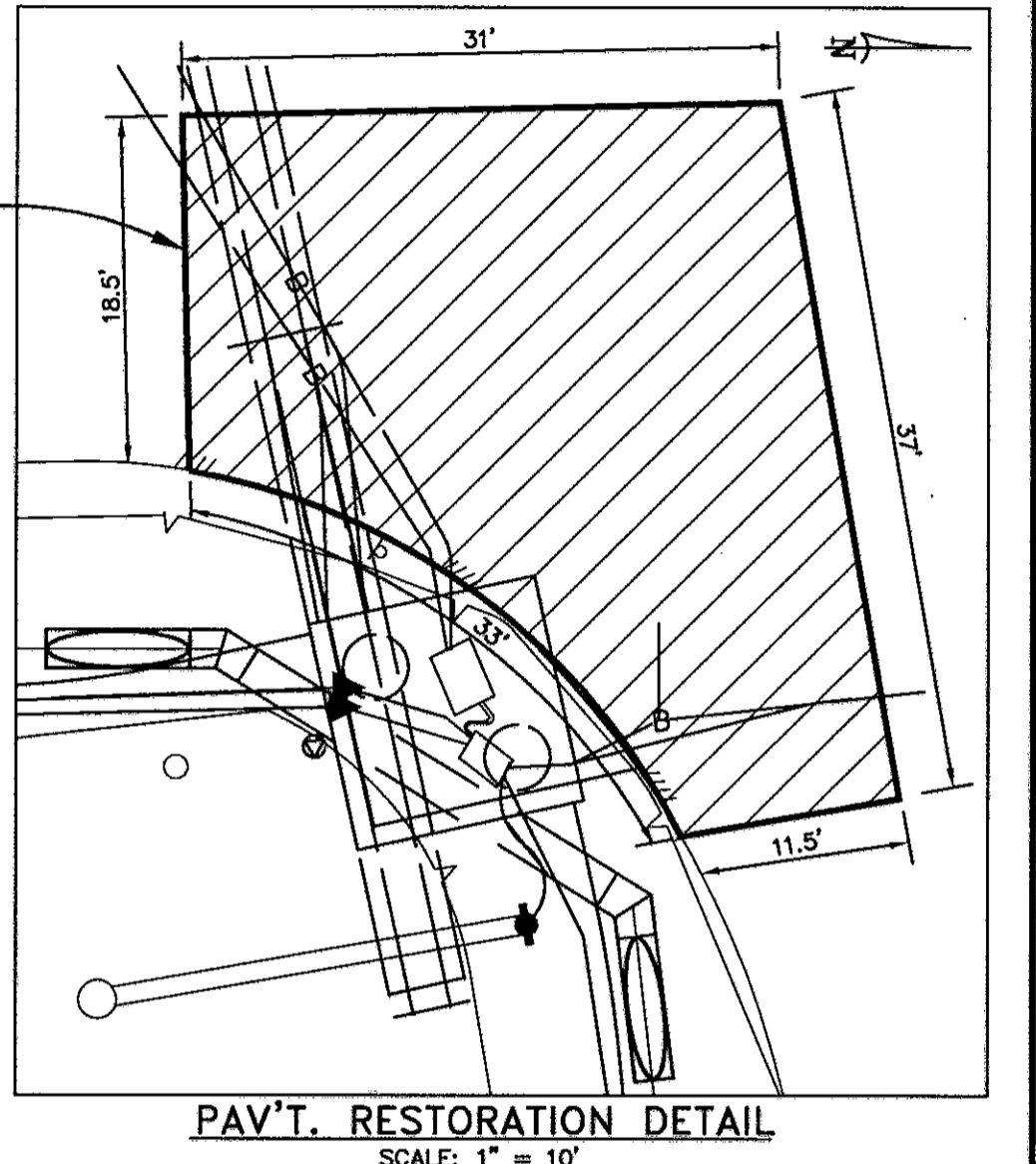
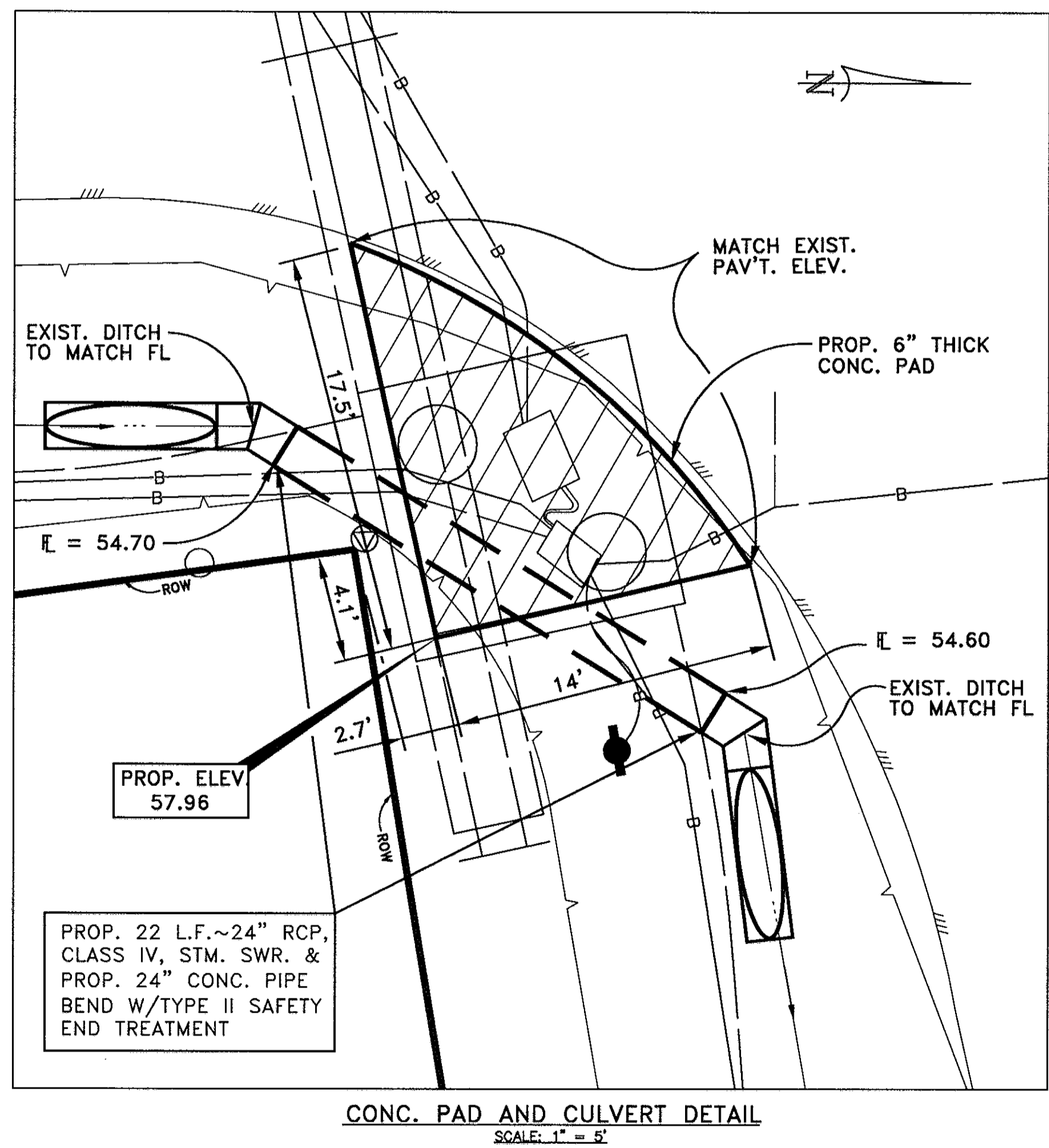
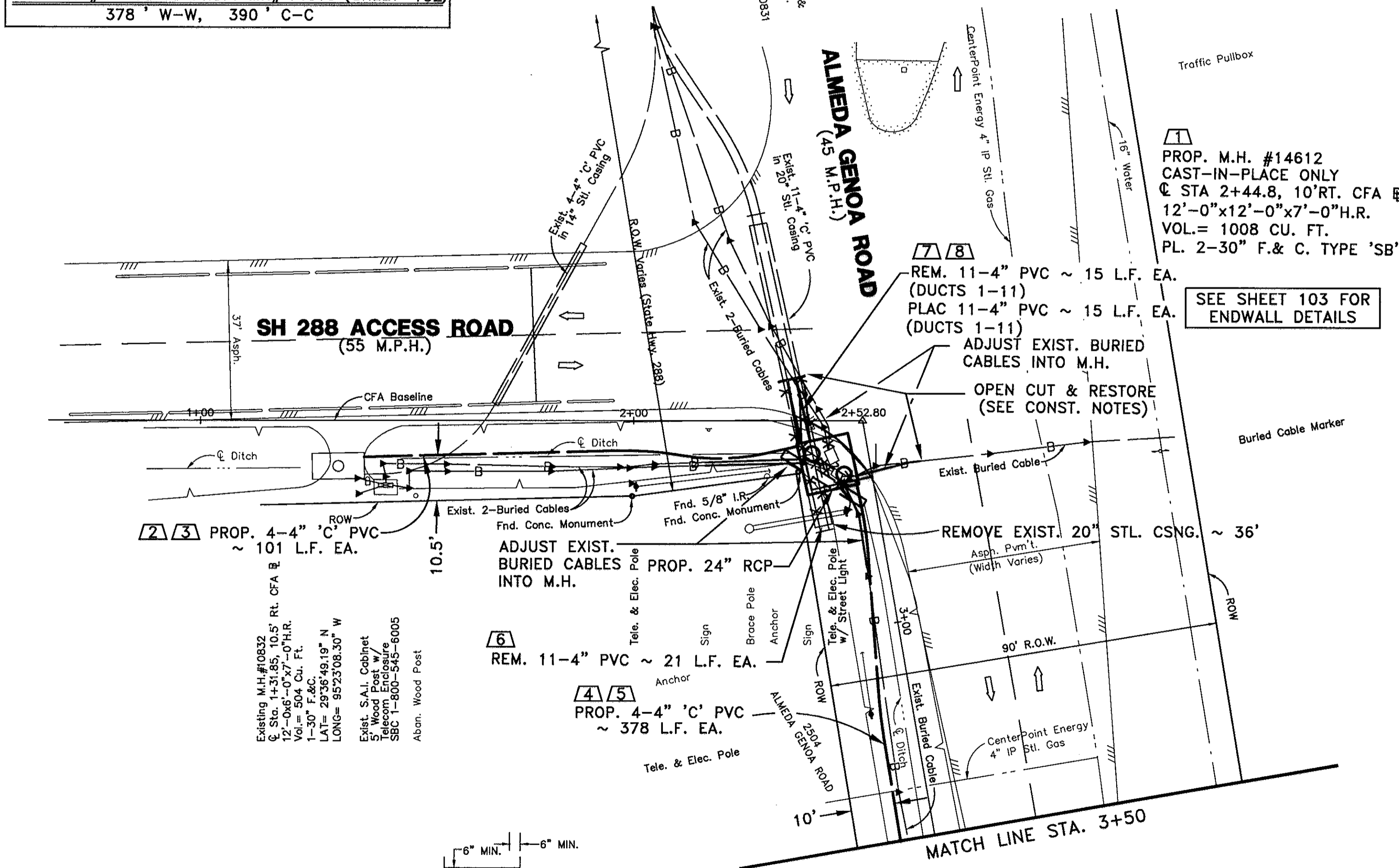

**SBC**

**ALMEDA-GENOA @ SH 288 & HYCOHEN**  
 HOUSTON, TEXAS

C.P.# \_\_\_\_\_  
 PREPARED BY \_\_\_\_\_  
 PREPARED BY CONDUIT DISTRICT \_\_\_\_\_  
 PROJECT NO. \_\_\_\_\_  
 AREA NO. WK-4433 c.o. IDLEWOOD '433' TAX DIST. HG-031

REC REF SHEET 101

NOTE: CITY SIGNATURES VALID FOR ONE YEAR ONLY AFTER DATE OF SIGNATURES

**CITY OF HOUSTON**  
 DEPARTMENT OF PUBLIC WORKS AND ENGINEERING

WATER 9/14/06  
 WASTEWATER 9/14/06  
 STORM 9/14/06  
 FACILITIES 9/14/06

FILE NO: \_\_\_\_\_  
 DRAWING SCALE: \_\_\_\_\_  
 HORZ : 20'  
 VERT : 4'  
 SHEET No: 4 OF 10

FOR CITY OF HOUSTON USE ONLY

42399  
 CITY DRAWING NUMBER

CFA File: D:\CFA\2006\0603\alameda\alameda.dwg  
 User: jgarcia  
 Date: 09/12/2006 10:30:43 AM

**BENCHMARK:**  
 TRAV. #2: PK Nail w/ Shiner Located at the IH-288 Access Road and Alameda-Genoa on Asphalt Road on East Side of IH-288 Access Road on CFA Baseline at Sta. 2+52.80 Elev. = 57.51

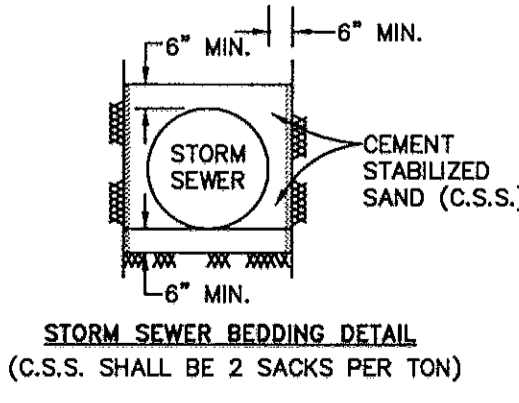

REVISION	REVISION DATE	DESCRIPTION	INITIAL

▲ = SBC Tone Mark

**STATE OF TEXAS**  
**MONICA F. SILVER**  
 85589  
 LICENSED PROFESSIONAL ENGINEER

**Cobb**  
 Fendley  
 ENGINEERS

JOB NO. 0603-041-01 F.B.# 1815



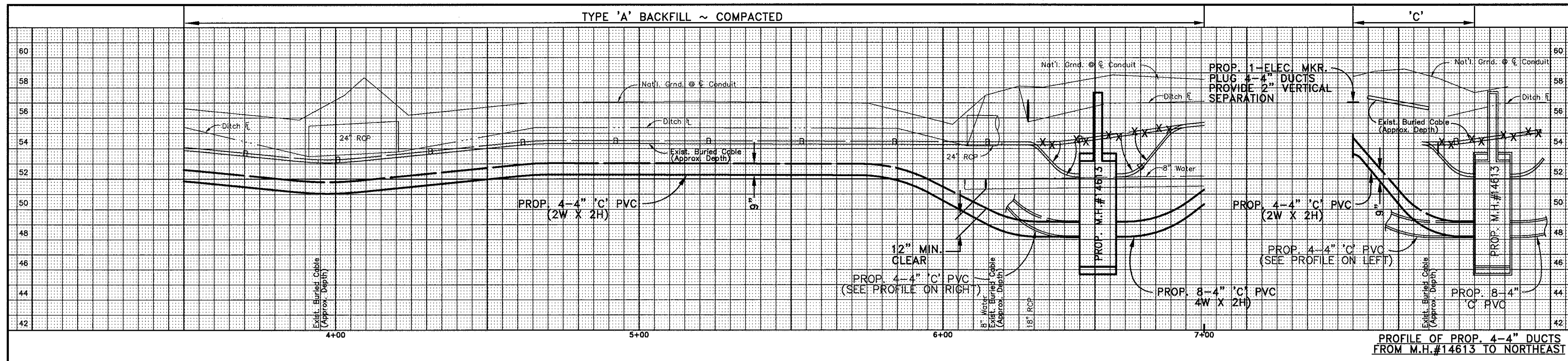

OPER	ACTION CODE	MAJOR MATERIAL DESCRIPTION	ACCT. CODE	ML OR AMT.	PL	BORE	REMOVALS AMOUNT	WORT DATE
1	PLAC	MANHOLE	4C		1			
2	PLAC	TRENCH-4-MPC	4C	40'				
3	PLAC	PVC-C-4", 4	4C		160'			
4	PLAC	TRENCH-8-MPC	4C	149'				
5	PLAC	PVC-C-4", 8	4C		1192'			

PROP. MH# 14613 TO RT SITE BLDG. (SHEET 103)  
149' W-W 155' C-W

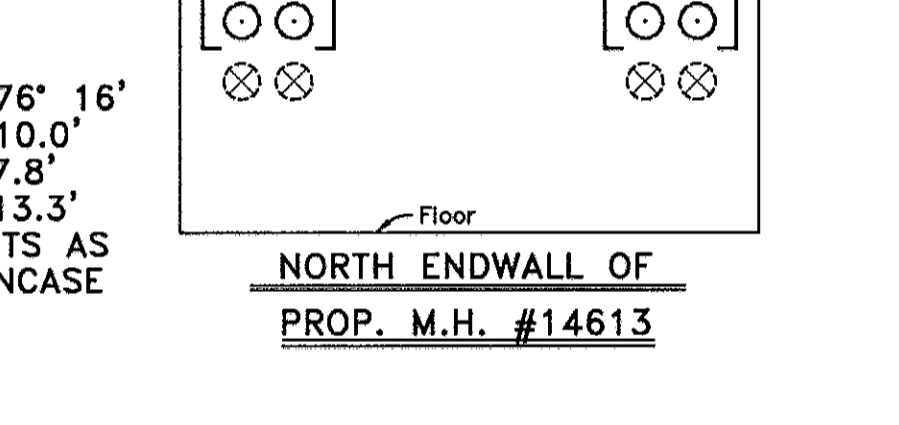
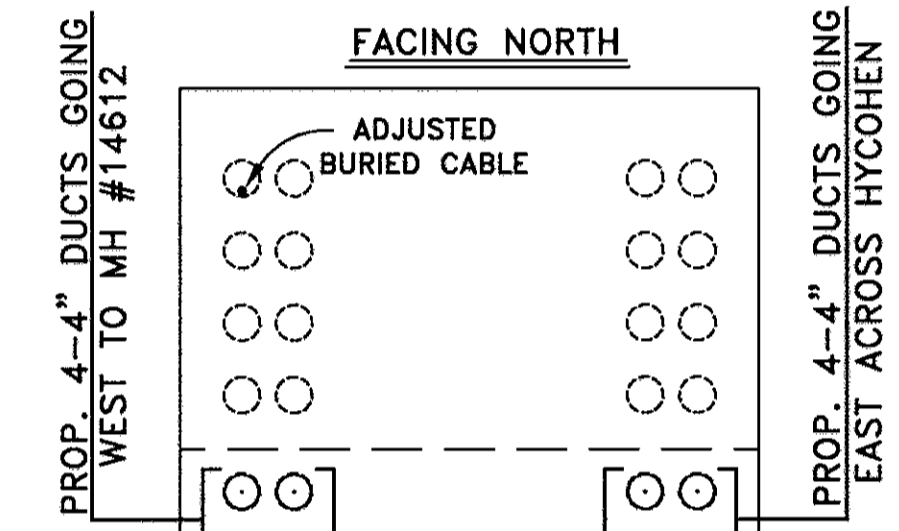
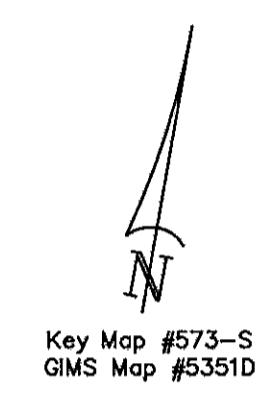
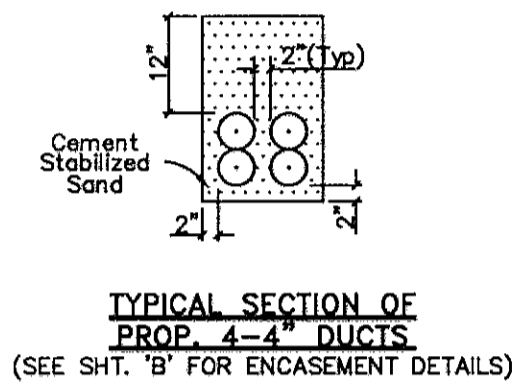

**CURVE DATA**  
 $\Delta 1 = 89^\circ 15'$   $\Delta 2 = 76^\circ 16'$   
 $R = 12.0'$   $R = 10.0'$   
 $T = 11.8'$   $T = 7.8'$   
 $L = 18.6'$   $L = 13.3'$   
 USE CURVE SEGMENTS AS REQUIRED; CONC. ENCASE

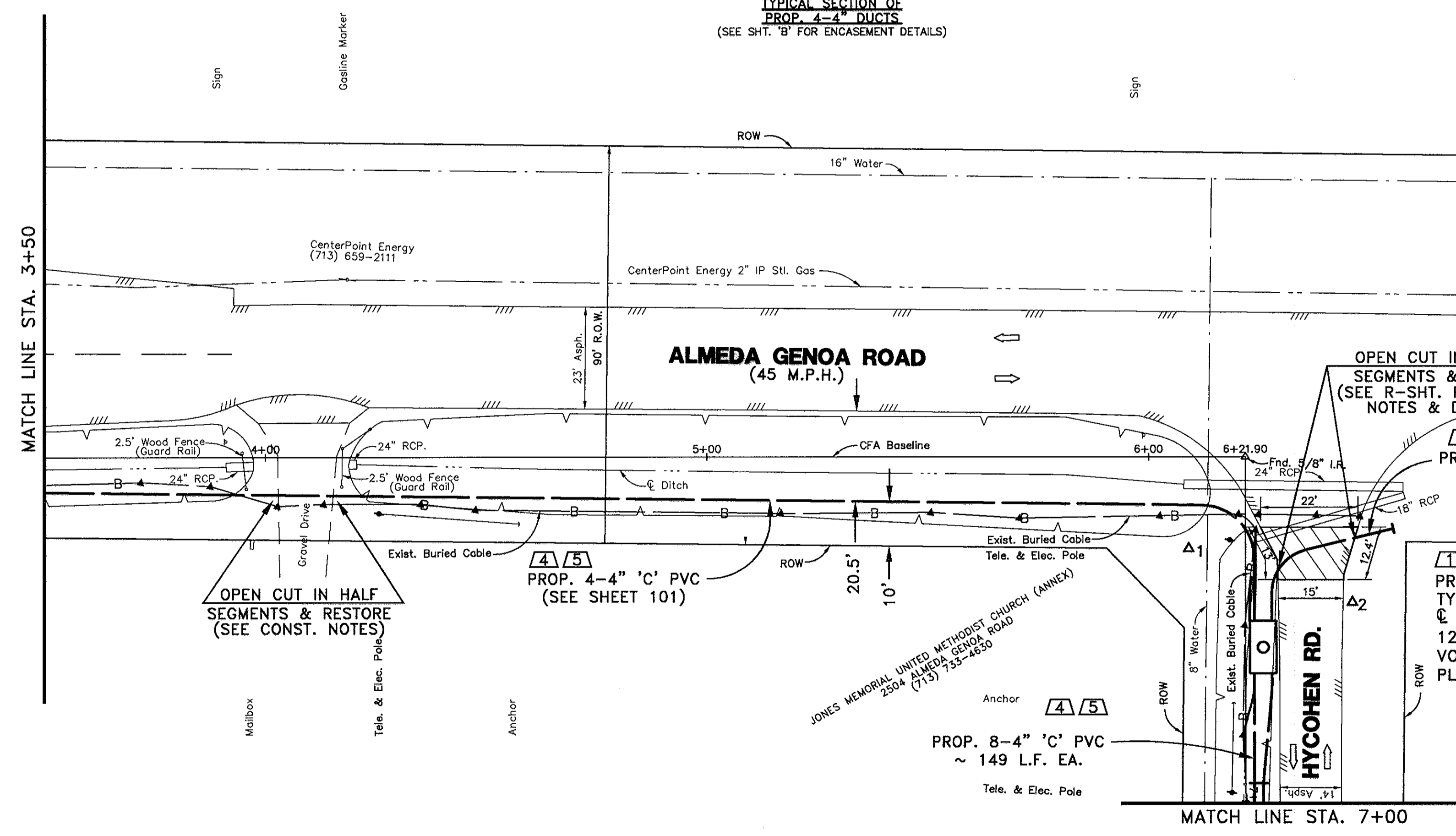

1 PROP. M.H. #14613  
 TYPE 'A' PRECAST  
 Q. STA 6+65, 4.0' LT. CFA R  
 12'-0" x 6'-0" x 7'-0" H.R.  
 VOL. = 504 CU. FT.  
 PL. 1-30" F. & C. TYPE 'SB'

**SBC**  
**ALMEDA-GENOA @ SH 288 & HYCOHEN**  
 HOUSTON, TEXAS

C.P.# \_\_\_\_\_  
 PREPARED BY \_\_\_\_\_  
 DRAWN BY \_\_\_\_\_  
 ISSUE DATE \_\_\_\_\_

PROJECT NO. \_\_\_\_\_  
 AREA NO. WK-4433 C.O. IDLEWOOD '433' TAX DIST. HG-031

NOTE: CITY SIGNATURES VALID FOR ONE YEAR ONLY AFTER DATE OF SIGNATURES

**CITY OF HOUSTON**  
 DEPARTMENT OF PUBLIC WORKS AND ENGINEERING

WATER \_\_\_\_\_  
 WASTEWATER \_\_\_\_\_  
 STORM \_\_\_\_\_  
 FACILITIES \_\_\_\_\_

STREET & BRIDGE \_\_\_\_\_  
 TRAFFIC \_\_\_\_\_  
 STORM WATER QUALITY \_\_\_\_\_

FILE NO: \_\_\_\_\_  
 DRAWING SCALE \_\_\_\_\_  
 HORZ : 20'  
 VERT : 4'

SHEET No: 5 OF 10

FOR CITY OF HOUSTON USE ONLY

42899  
 CITY DRAWING NUMBER

REVISION	REVISION DATE	DESCRIPTION	INITIAL

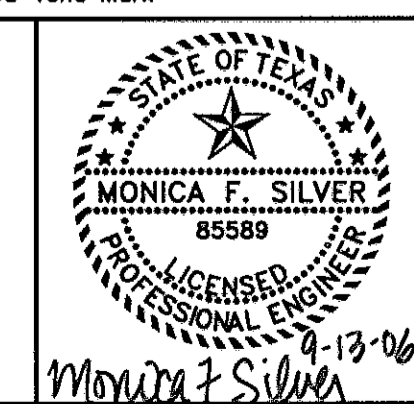

**BENCHMARK:**  
 TRAV. #3: PK Nail w/ Shiner Located at the Intersection of Almeda-Genoa & Hycohen Road on Asphalt Road on West Side of Hycohen Road on CFA Baseline at Sta. 6+21.95  
 Elev. = 59.08

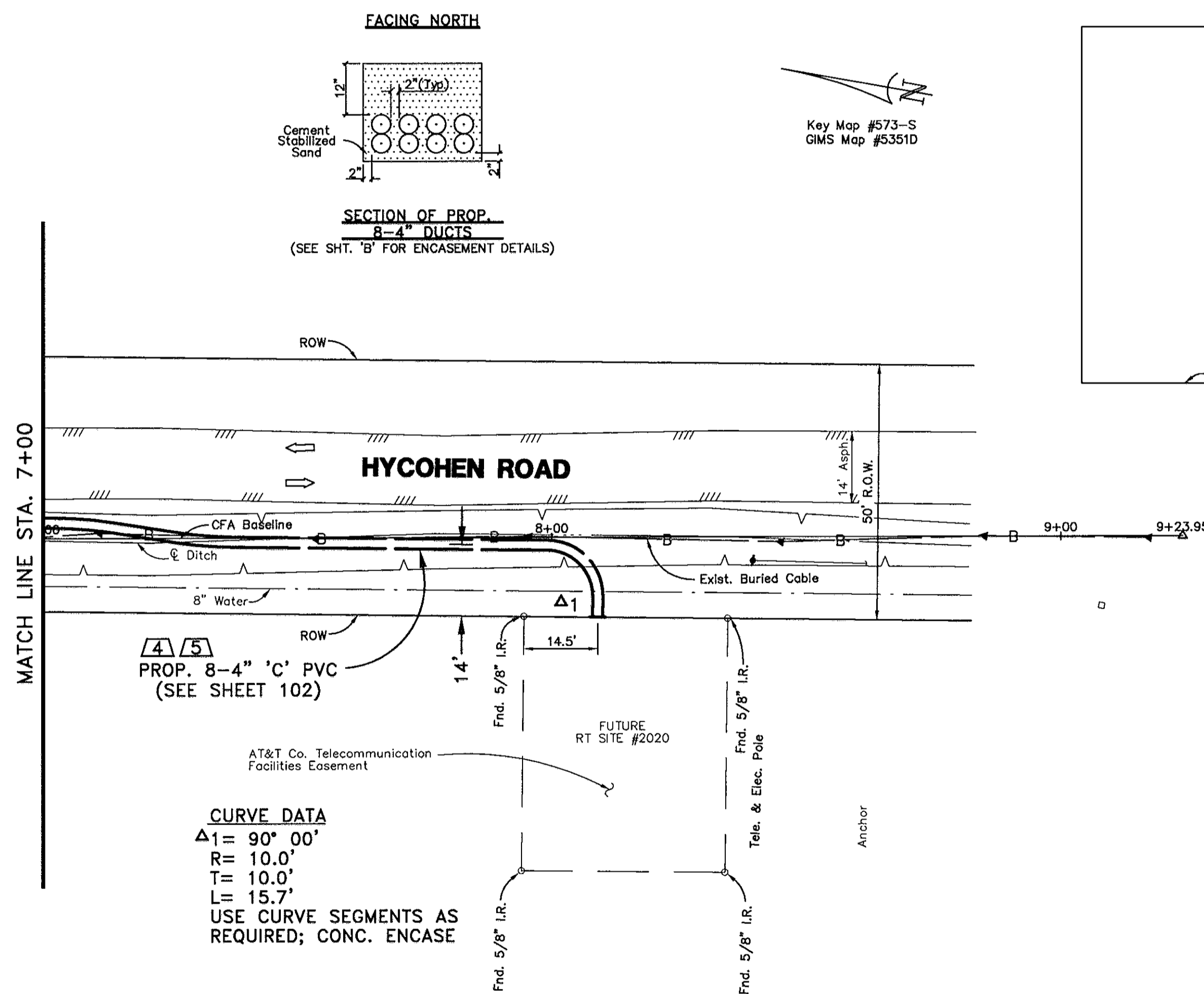
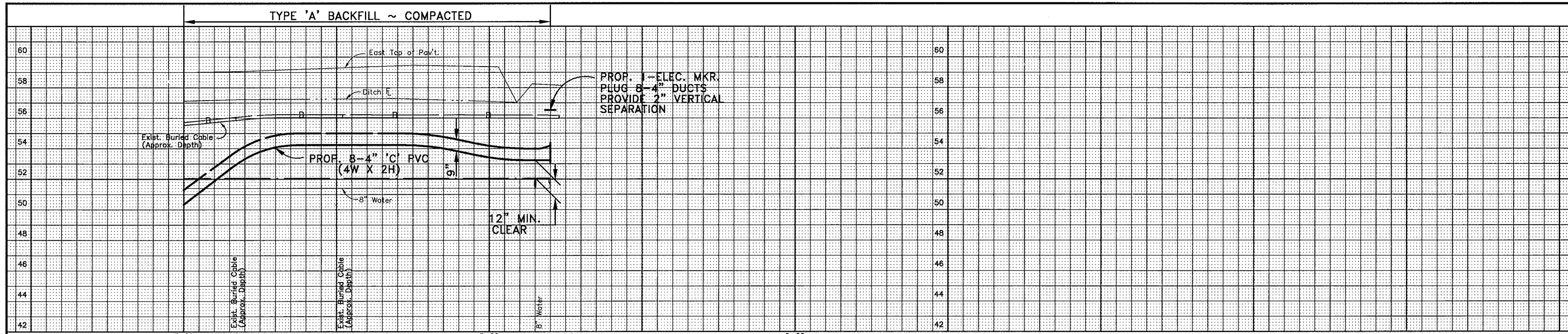

**CURVE DATA**  
 $\Delta 1 = 90^\circ 00'$   
 $R = 10.0'$   
 $T = 10.0'$   
 $L = 15.7'$   
 USE CURVE SEGMENTS AS  
 REQUIRED; CONC. ENCASE

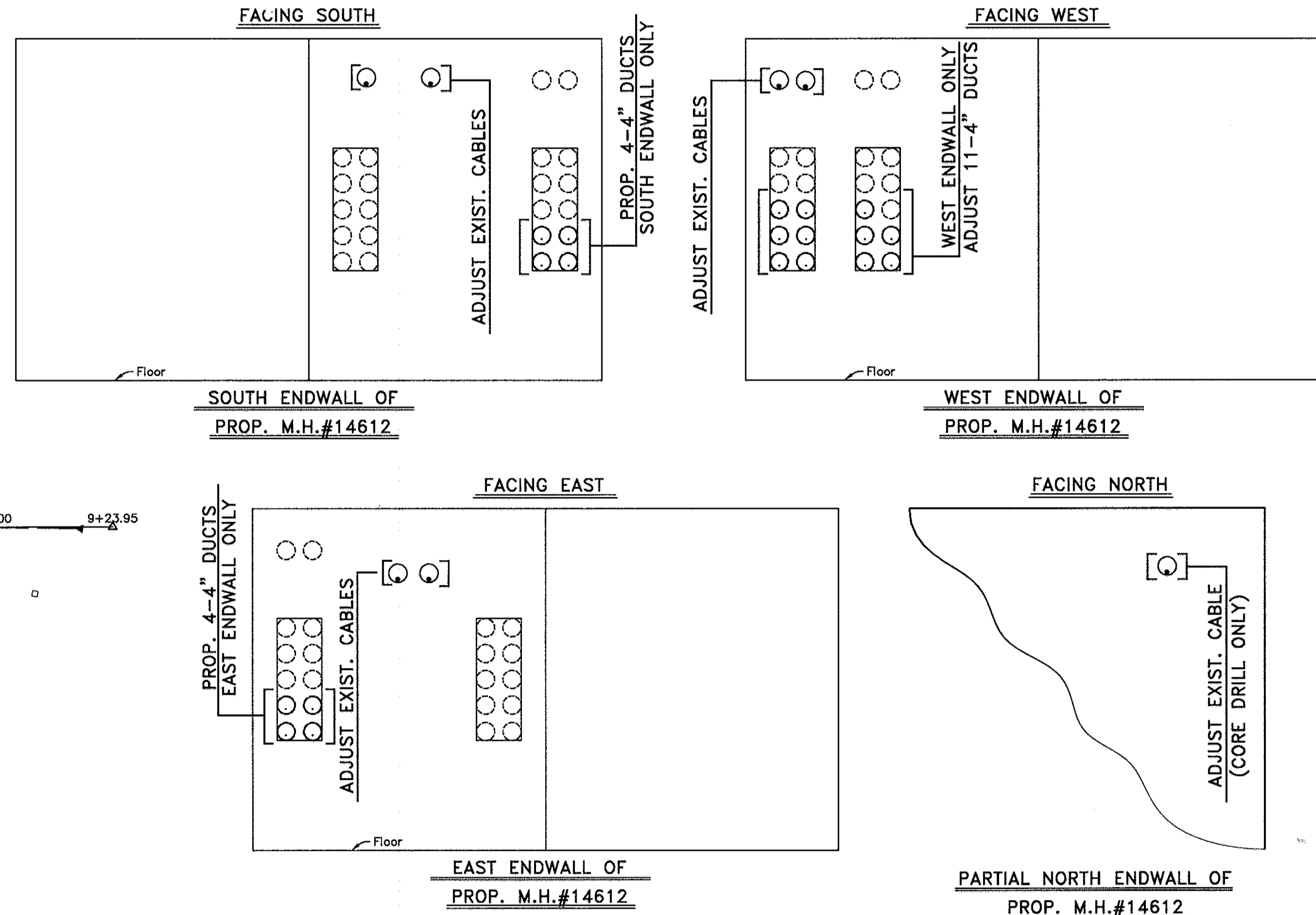
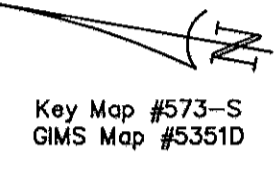
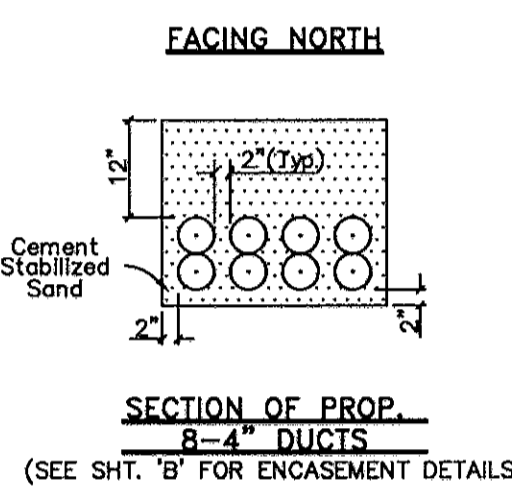

**SBC**  
**ALMEDA-GENOA @ SH 288 & HYCOHEN**  
**HOUSTON, TEXAS**

C.P.#		PREPARED BY	
PREPARED BY CONDUIT DISTRICT		REC REF	ISSUE DATE
PROJECT NO.	AREA NO.	TAX DIST.	SHEET
	WK-4433	c.o. IDLEWOOD '433'	103

**CITY OF HOUSTON**  
 DEPARTMENT OF PUBLIC WORKS AND ENGINEERING

WATER	STREET & BRIDGE
WASTEWATER	TRAFFIC
STORM	STORM WATER QUALITY
9/14/06	9-14-06

FILE NO:	FOR CITY OF HOUSTON USE ONLY
DRAWING SCALE	
HORIZ : 20'	
VERT : 4'	
SHEET No: 6	OF 10

SEE SHEET 101 FOR NOTES

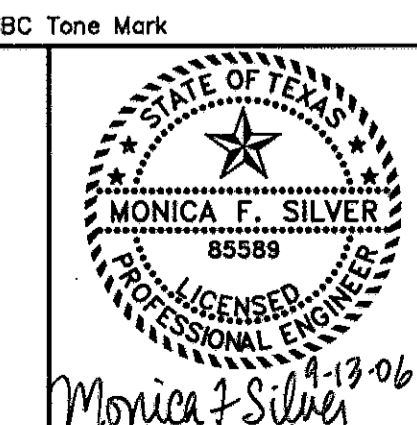

REVISION	REVISION DATE	DESCRIPTION	INITIAL

CFA, Info: D:\CFA\2006\04041\almeda\_genoa\hycohen\cfa\103.dwg  
 09/11/2006 09:37 103.dwg  
 42399

**BENCHMARK:**  
 TRAV. #3: PK Nail w/ Shiner Located at the intersection of Almeda-Genoa & Hycohen Road on Asphalt Road on West Side of Hycohen Road on CFA Baseline at Sta. 6+21.95  
 Elev. = 59.08