

**HOUSTON SOUTHWEST UNIT IDLEWOOD '433'**  
**PROPOSED DUCTS ALONG ALMEDA GENOA**  
**@ SOUTH HWY. 288**  
**HARRIS COUNTY, TEXAS**

**WK4433**

SHEET INDEX	
A	COVER SHEET
B	GENERAL DETAILS & SPECIFICATIONS
C	GENERAL DETAILS & SPECIFICATIONS
C1	GENERAL DETAILS & SPECIFICATIONS
D	TRAFFIC CONTROL PLAN
D1	TRAFFIC CONTROL PLAN
D2	TRAFFIC CONTROL PLAN
D3	TRAFFIC CONTROL PLAN
R	STREET CUT RESTORATION DETAILS
101	PLAN & PROFILE SHEET
102	PLAN & PROFILE SHEET
103	PLAN & PROFILE SHEET

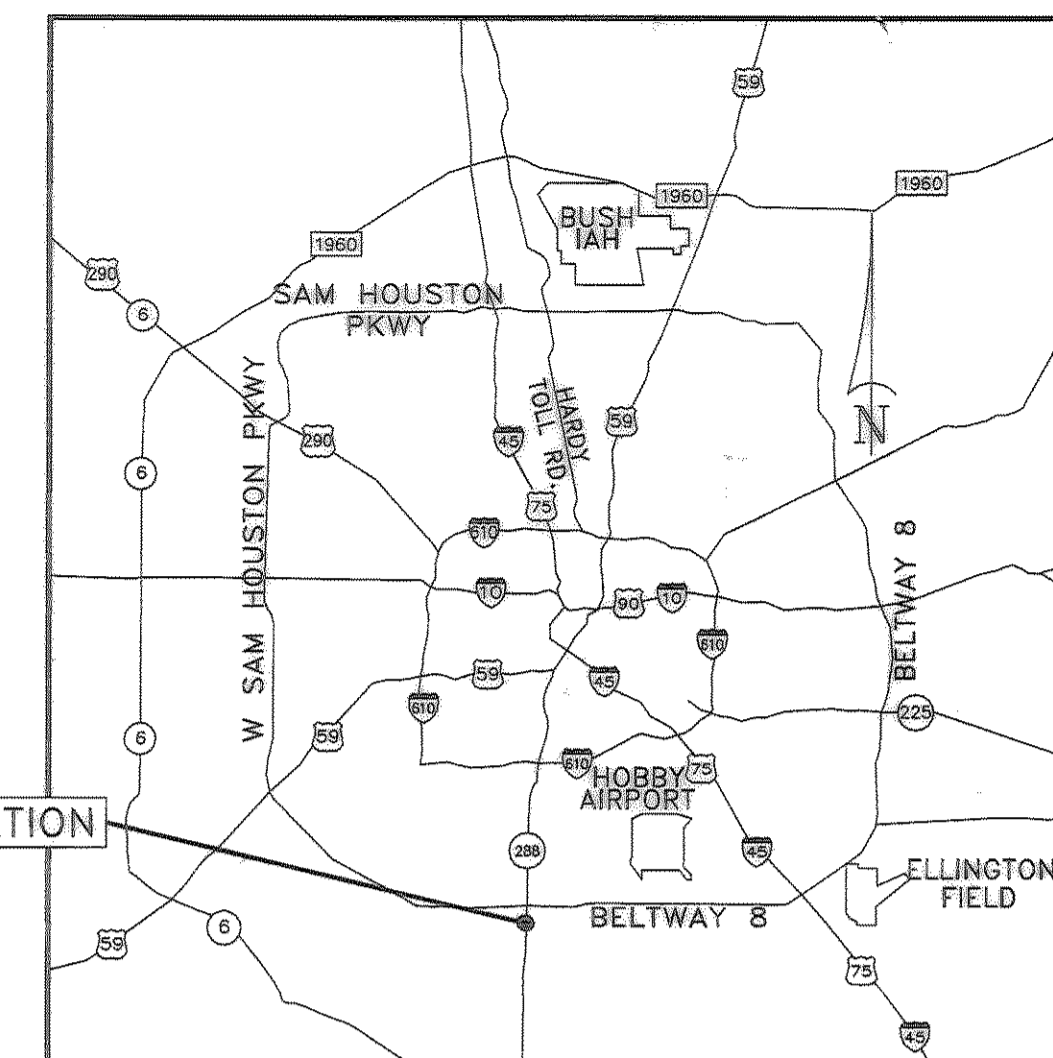

LOCATION MAP

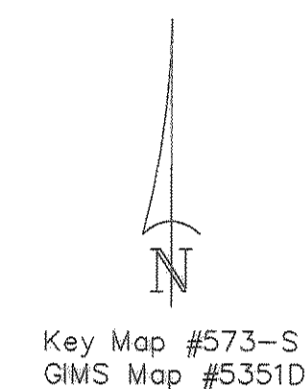

Key Map #573-S  
 GIMS Map #5351D

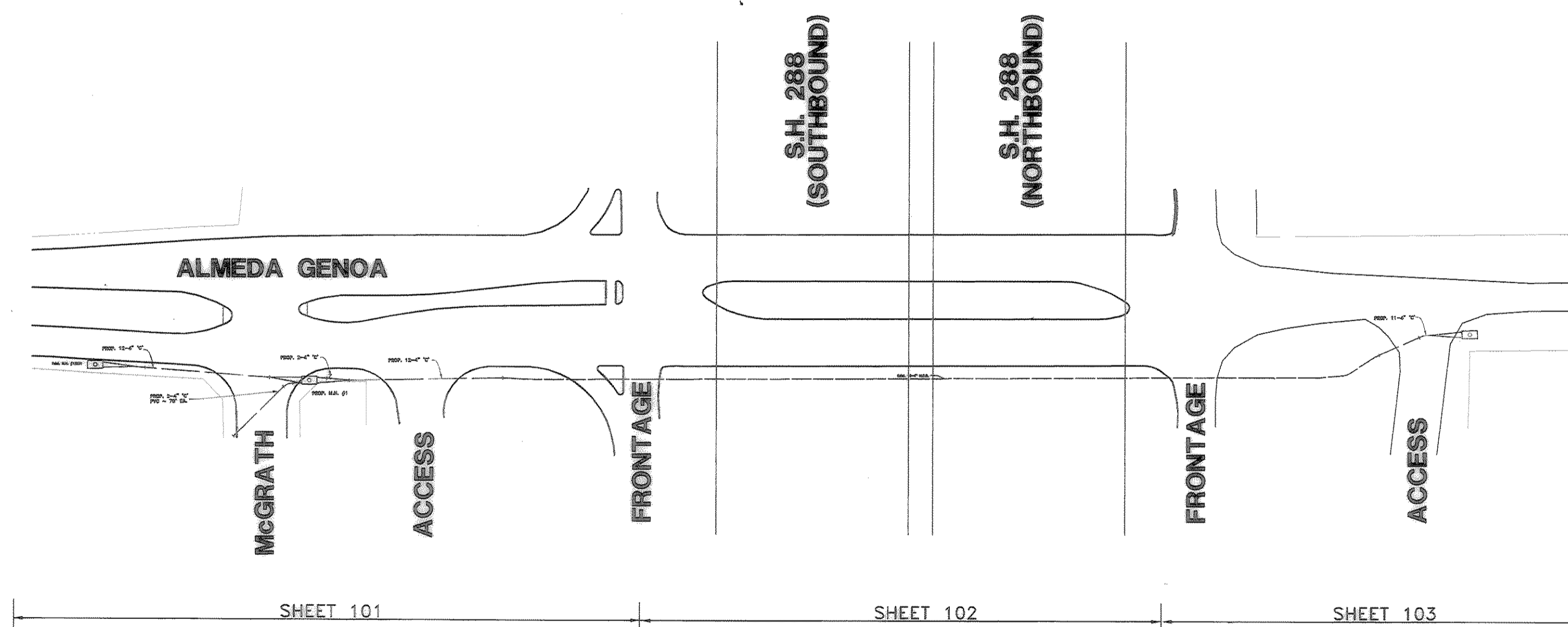

PROJECT MAP

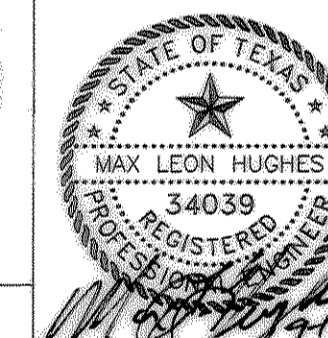

SURVEYED BY: S.E.	
WATER <i>9/11/03</i>	STORM WATER QUALITY <i>9-11-03</i>
WASTEWATER <i>9.11.03</i>	TRAFFIC AND TRANSPORTATION <i>Naam Anay</i>
STORM WATER <i>9.11.03</i>	WATER PRODUCTION
STREET & BRIDGE <i>9/11/03</i>	
CITY ENGINEER <i>9/15/03</i>	
DIRECTOR OF PUBLIC WORKS AND ENGINEERING <i>9-12-03</i>	
SHEET NO 1 OF 12 SHEETS	

COH Log No. 03-0967

Contractor shall comply with City of Houston Street Cut Ordinance.

THIS PROJECT HAS BEEN DETERMINED TO BE OUTSIDE THE 100-YEAR FLOOD PLAN AND IS IN ZONES X, AS SHOWN ON ABOVE VICINITY MAP. ACCORDING TO THE FIRM MAP NUMBER 48201C0880 K, REVISED APRIL 20, 2000 PANEL 880 OF 1135.

Contractor shall notify the City of Houston, Department of Public Works and Engineering, Engineering Construction Division (Telephone No. 713-863-1450) 48 hours before starting work on this project.

CP# 703-005	PROJECT NO. 5100466	A
AREA NO. WK4433	DATE ISSUED 10/24/03	
NUMBER OF SHEETS 12		

PROPOSED DUCTS ALONG ALMEDA GENOA @ SOUTH HWY. 288



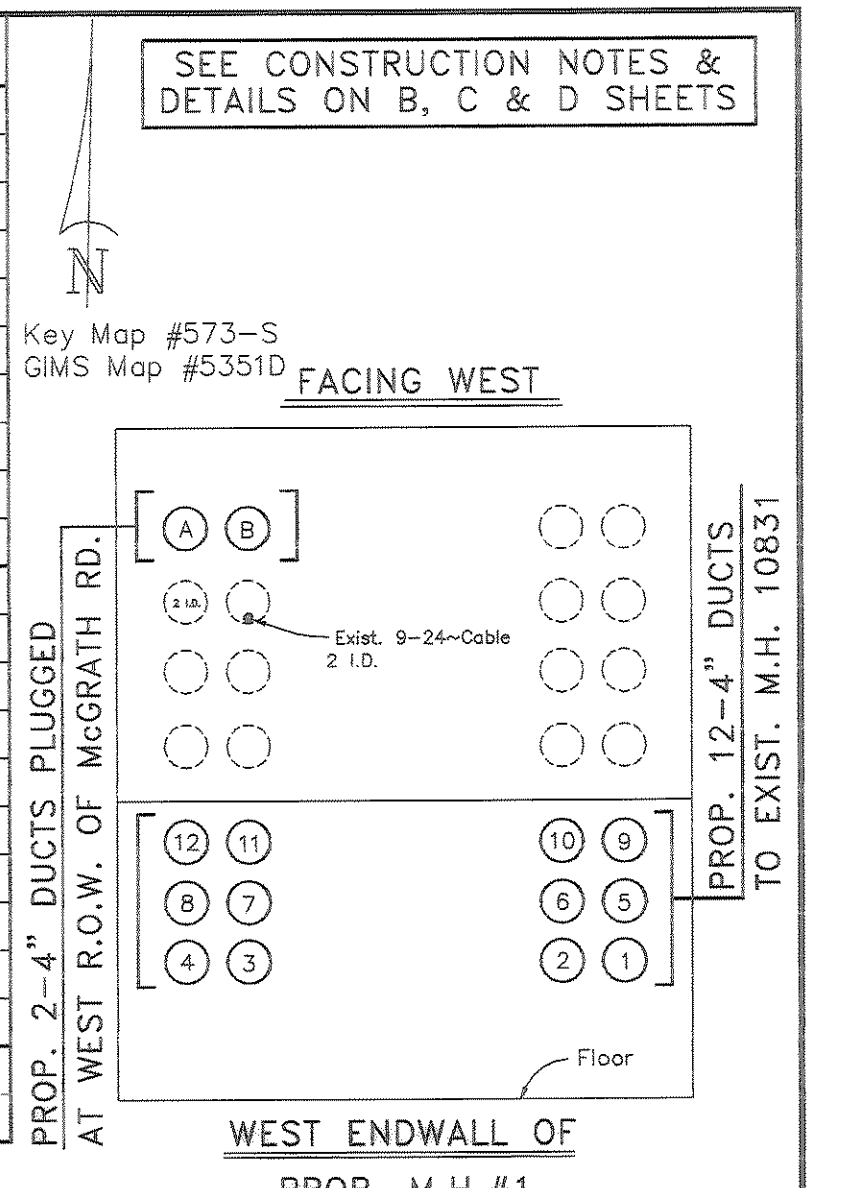
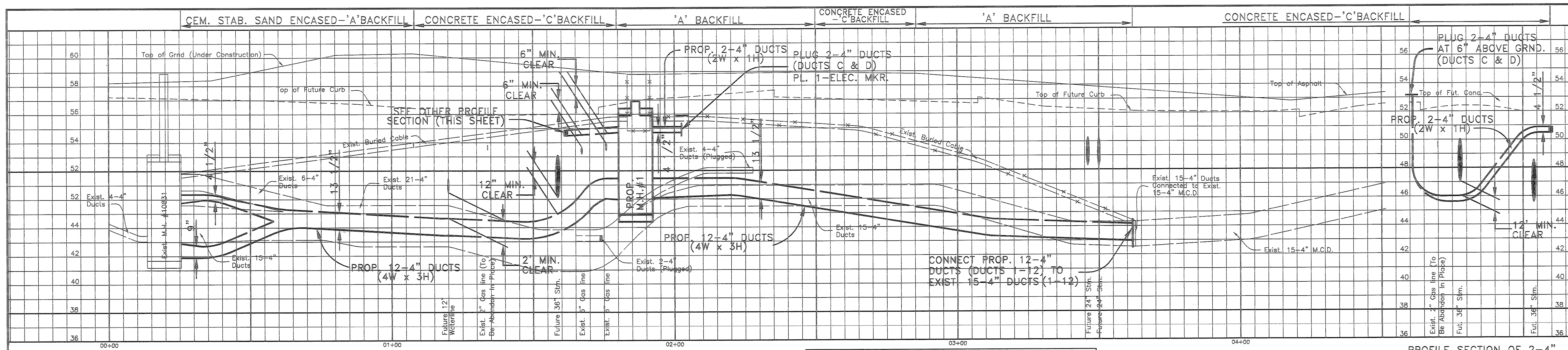

NOTE: CONTRACTOR TO VERIFY FUTURE R.O.W. HAS BEEN ACQUIRED PRIOR TO CONSTRUCTION

NOTE: DUCT ASSIGNMENT CHANGES REQUIRE APPROVAL FROM SBC INSPECTOR

EXIST. MH #10831 TO PROP. MH #1  
155' W-W, 167' C-C

PROP. MH #1 TO PROP. MH #2 (SHEET 103)  
900' W-W, 912' C-C

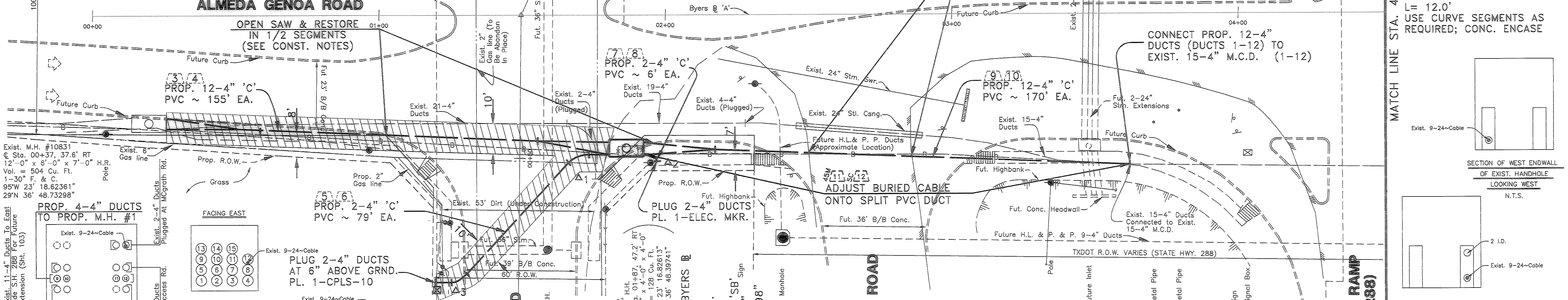
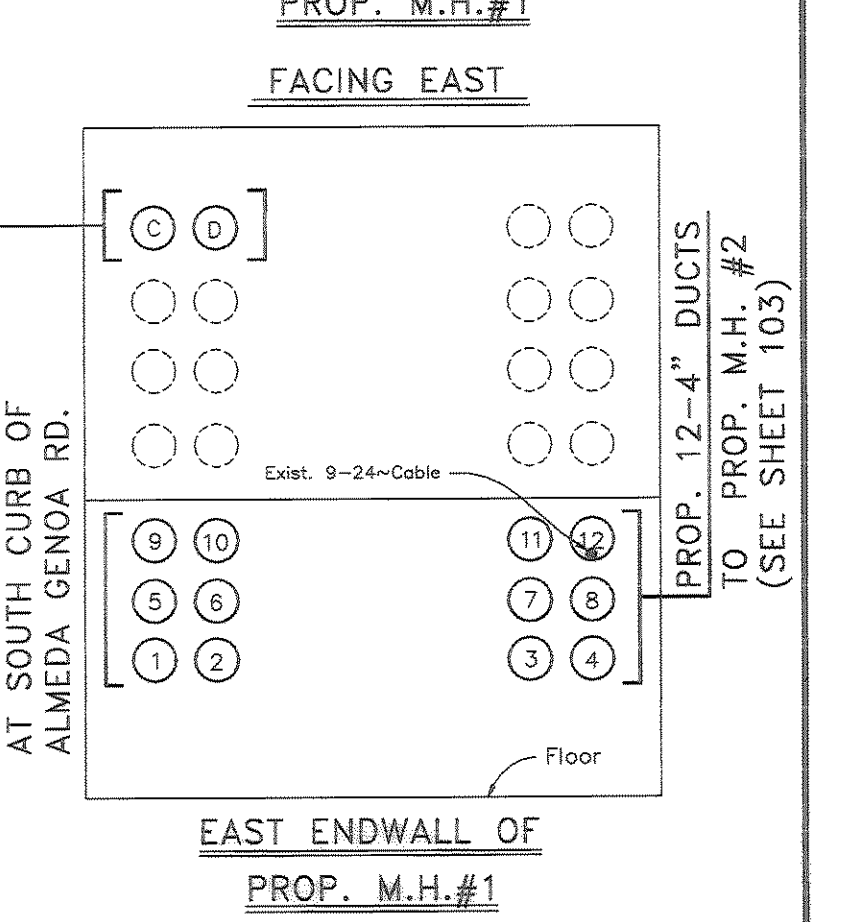
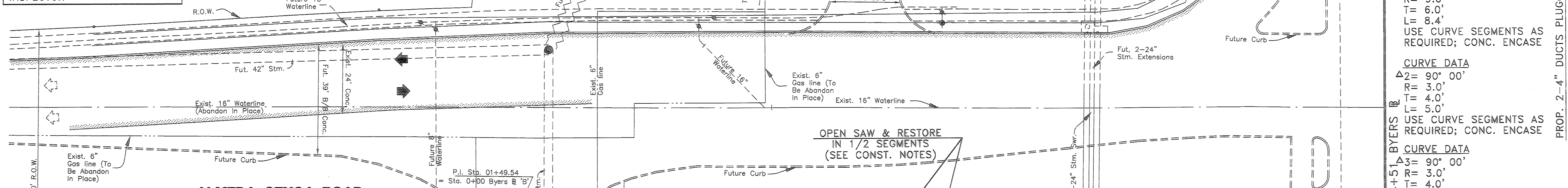

**CITY OF HOUSTON**  
DEPARTMENT OF PUBLIC WORKS AND ENGINEERING

REVIEWED BY  
CITY FUNDED PUBLIC WORKS

PROJECT MANAGER  
CONSTRUCTION  
CHIEF ENGINEER

TRAFFIC AND TRANSPORTATION  
SPONSOR DEPARTMENT

DATE: 9/15/03

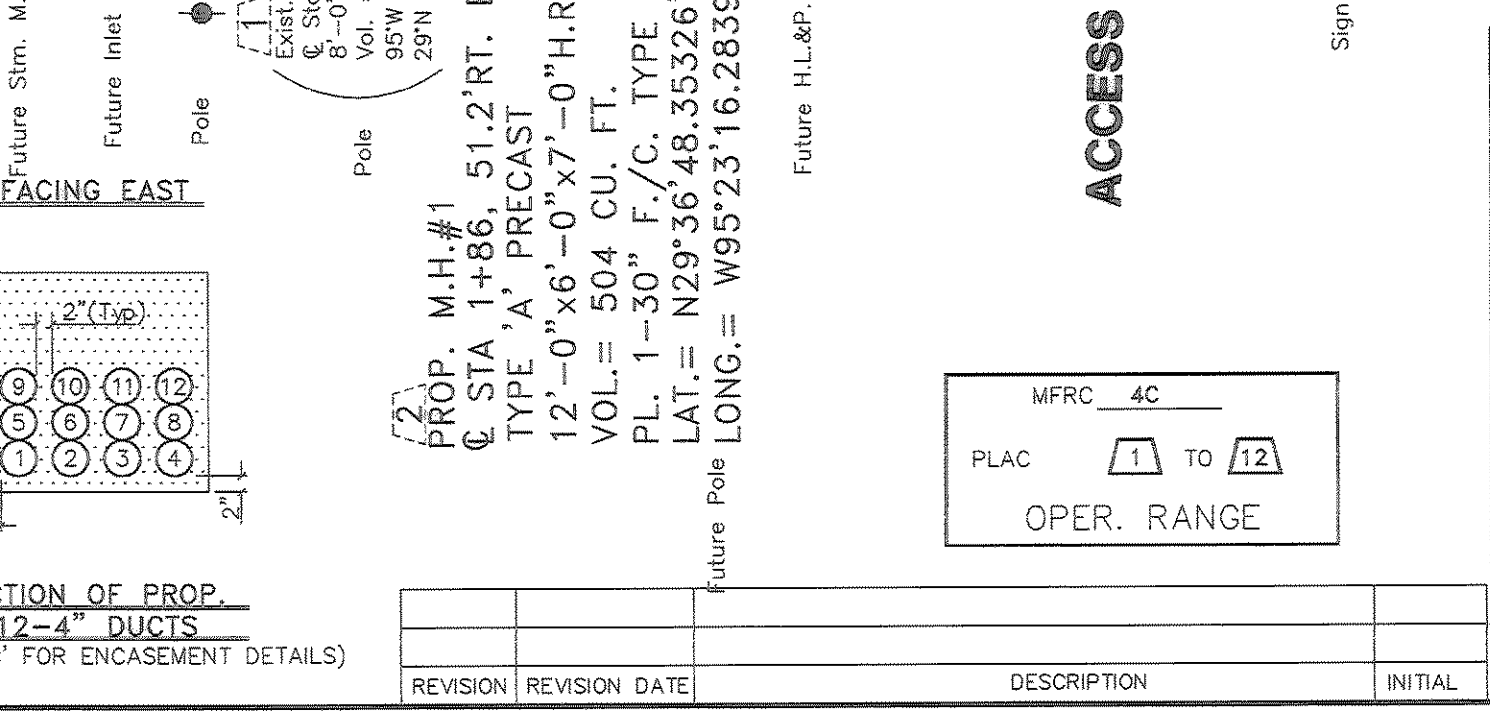
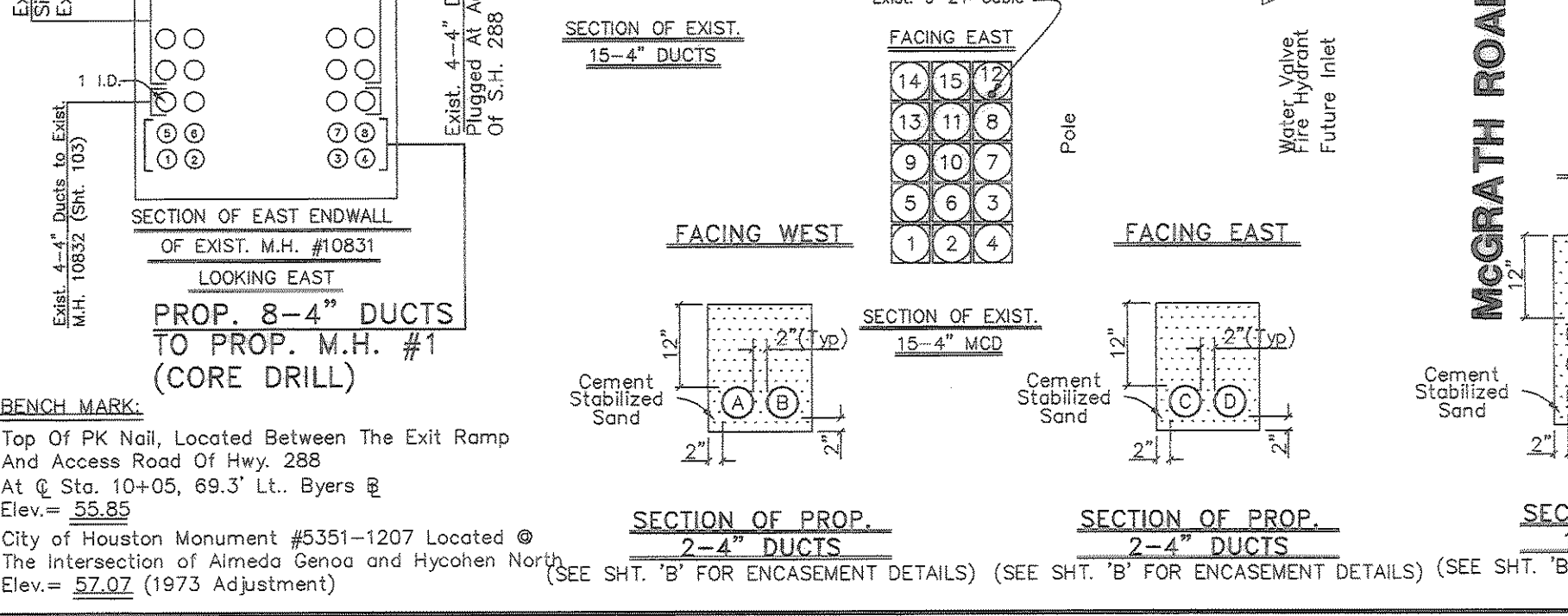

OPER	ACTION CODE	MAJOR MATERIAL DESCRIPTION	ACCT. CODE	ML OR AMT.	PL	BORE	REMOVALS
							AMOUNT
1	REMO	HANDHOLE	4X				1 '00
2	PLAC	MANHOLE	4C		1		
3	PLAC	TRENCH-12-MPC	4C	155'			
4	PLAC	PVC-C-4", 12	4C		1860'		
5	PLAC	TRENCH-2-MPC	4C	79'			
6	PLAC	PVC-C-4", 2	4C		158'		
7	PLAC	TRENCH-2-MPC	4C	6'			
8	PLAC	PVC-C-4", 2	4C		12'		
9	PLAC	TRENCH-12-MPC	4C	170'		70'	
10	PLAC	PVC-C-4", 12	4C		2040'		
11	RELO	RETIRE BURIED CABLE	45X		170'		
12	PLAC	SPLIT PVC CASING	4C		170'		

**PROPOSED DUCTS ALONG ALAMEDA GENOA @ HWY. 288**

SCALE: PLAN 1" = 20' PROFILE VERT. 1" = 4' PROFILE HORIZ. 1" = 20'

C.P.# 703-005

PREPARED BY: *Wade A. Skelton*

PROJECT NO. 5100466 REC REF ID-E2-19A

AREA WK4433 DIST. C.O.DLEWOOD'433' TAX DIST. HGO31

DATE: 9/15/03

JOB # FTH02685



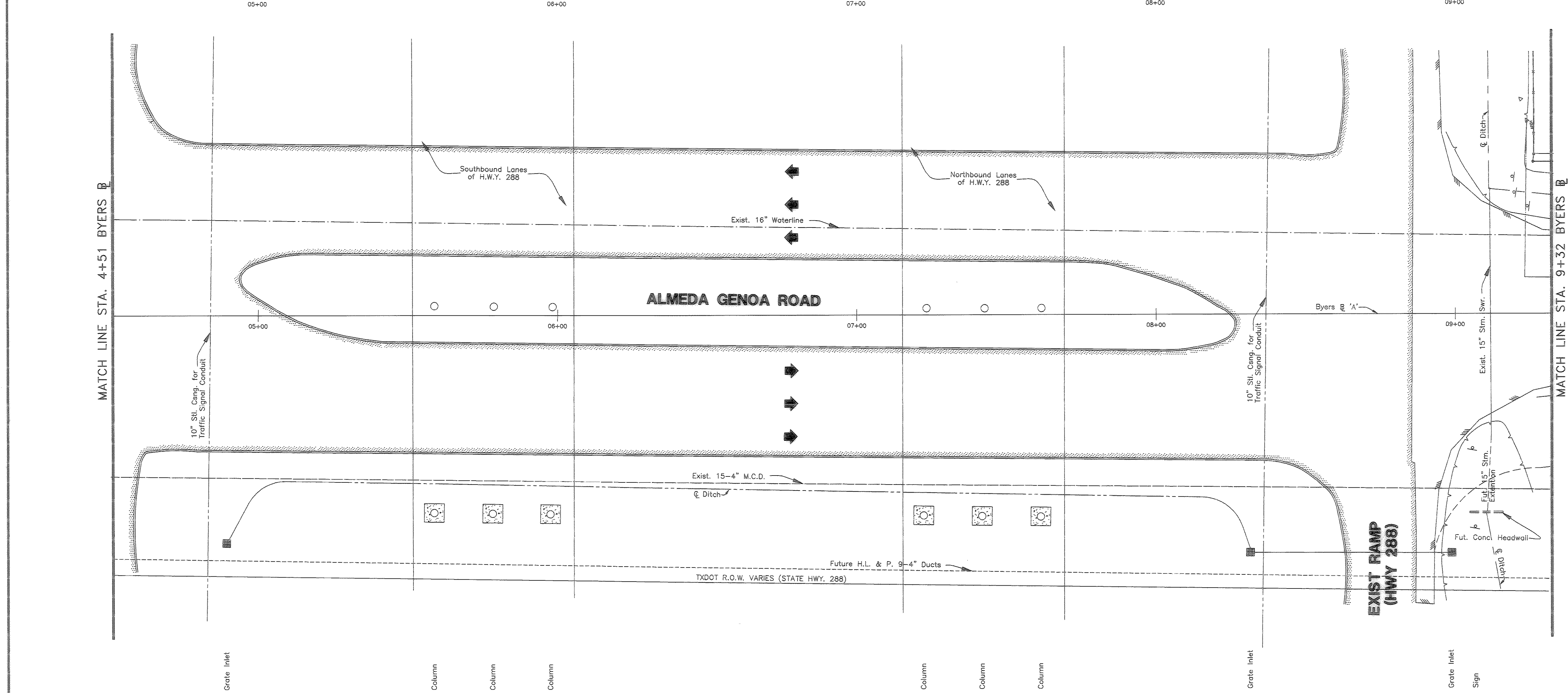
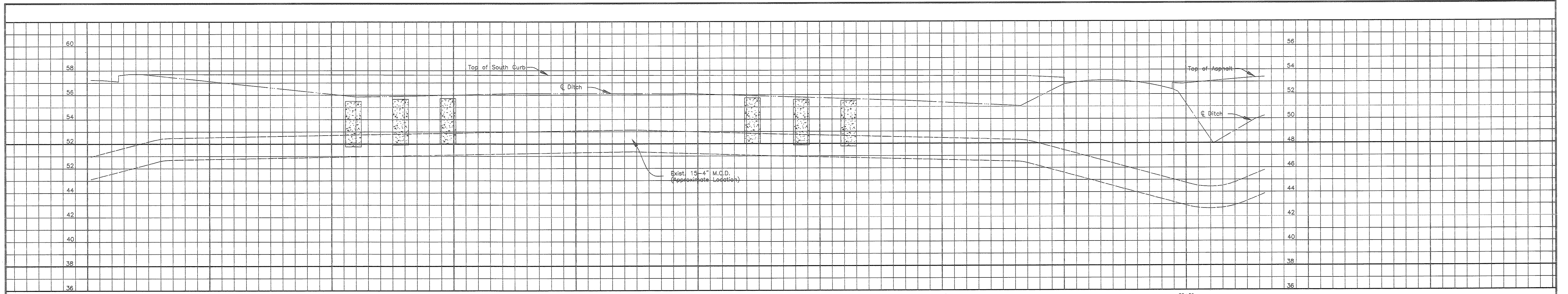

Key Map #573-S  
GIMS Map #5351D

**CITY OF HOUSTON**  
DEPARTMENT OF PUBLIC WORKS AND ENGINEERING

REVIEWED BY  
CITY FUNDED PUBLIC WORKS  
PROJECT MANAGER  
CONSTRUCTION  
CHIEF ENGINEER  
OTHER APPROVAL  
SPONSOR DEPARTMENT  
DATE

9/11/03  
9/11/03  
9/11/03  
9/11/03

9/11/03  
9/11/03

9/11/03

**PROPOSED DUCTS ALONG  
ALMEDA GENOA @ HWY. 288**

SCALE: PLAN 1"= 20' PROFILE VERT. 1"= 4" PROFILE HORZ. 1"= 20'

C.P.# 703-005

PREPARED BY [Signature]

PREPARED BY CONDUIT DISTRICT [Signature]

PROJECT NO. 5100466 REC REF ID-E2-19A SHEET 102

AREA NO. WK4433 C.O. IDLEWOOD '433' TAX DIST. HGO31

**BENCH MARK:**  
Top Of PK Nail, Located Between The Exit Ramp  
And Access Road Of Hwy. 288  
At @ Sta. 10+05, 69.3' Lt. Byers @  
Elev. = 58.85

City of Houston Monument #5351-1207 Located @  
The Intersection of Almeda Genoa and Hycohen North  
Elev. = 57.97 (1973 Adjustment)

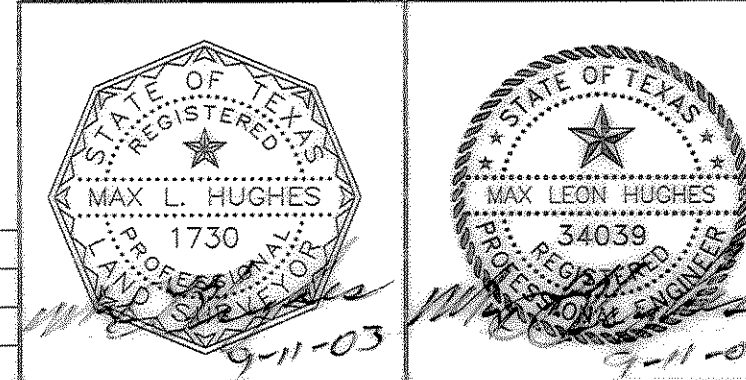

REVISION	REVISION DATE	DESCRIPTION	INITIAL



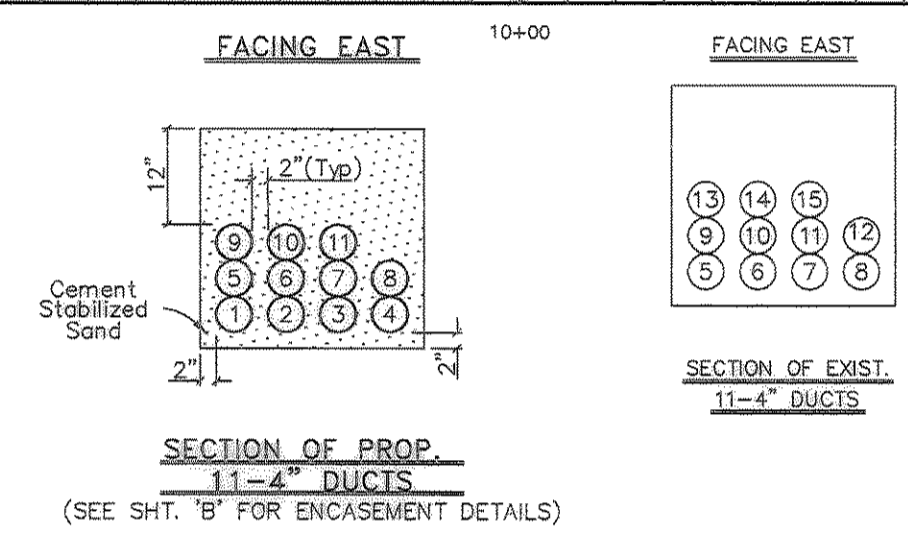
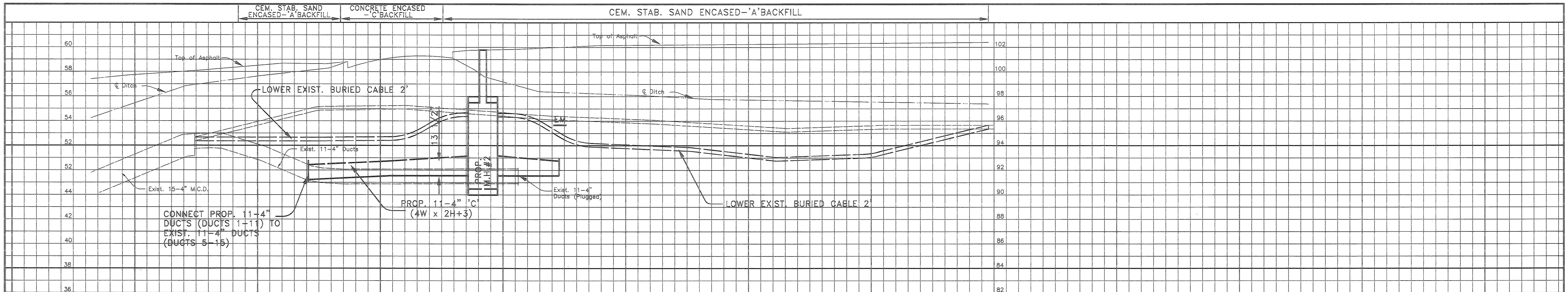

PROP. MH #1 TO PROP. MH #2 (SHEET 101)  
900' W-W, 912' C-C

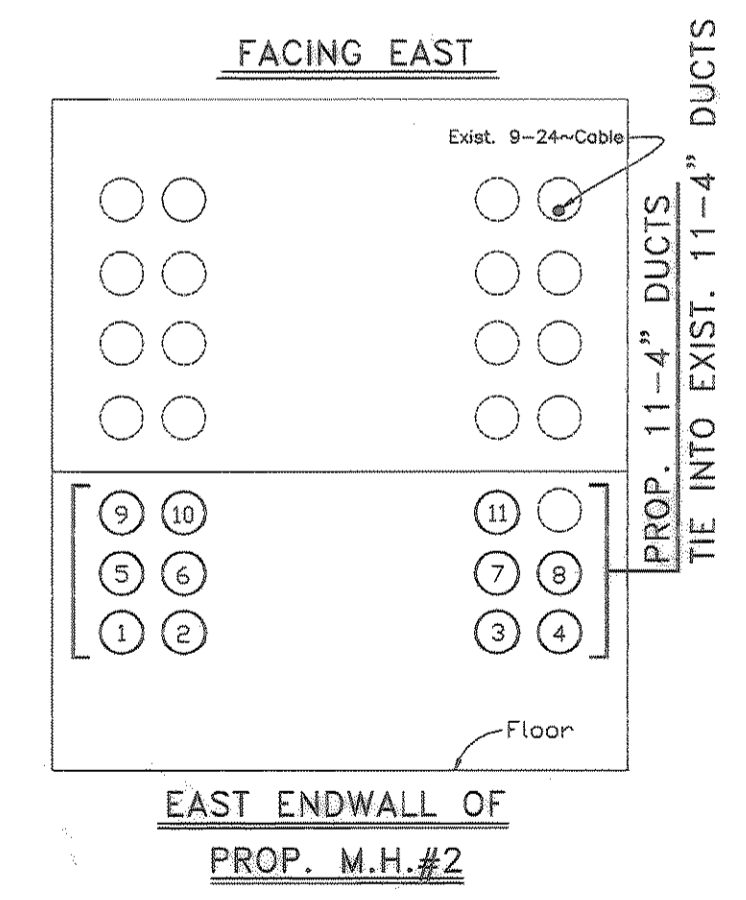
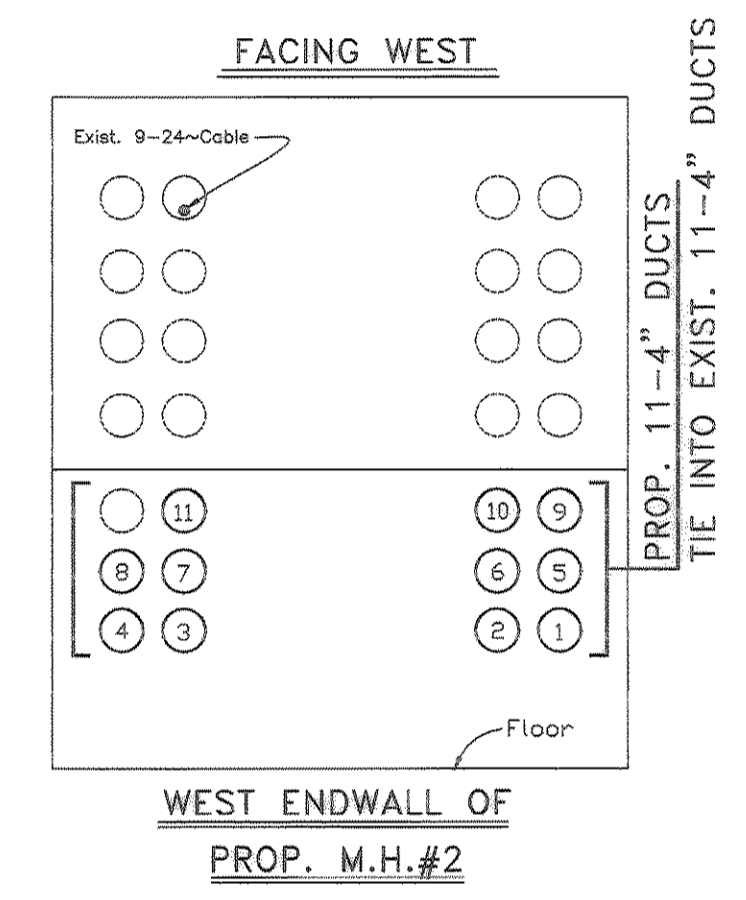

Key Map #573-S  
GMS Map #5351D

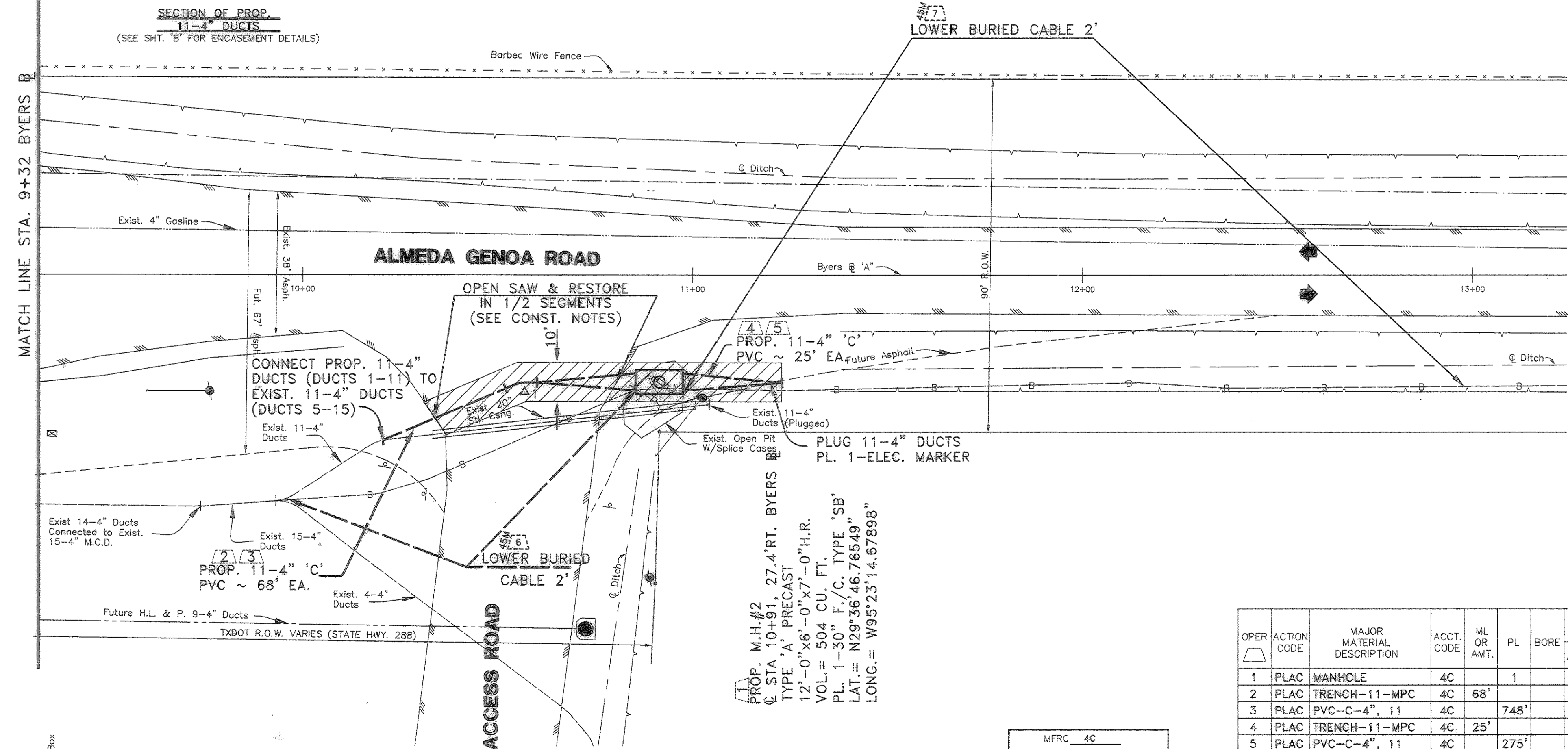

PROP. M.H.#2  
@ STA 10+91, 27.4' RT. BYERS  
TYPE 'A' PRECAST  
12'-0\"/>

CURVE DATA  
Δ = 36° 00'  
R = 13.3'  
T = 4.3'  
L = 8.3'  
USE CURVE SEGMENTS AS  
REQUIRED; CONC. ENCASE

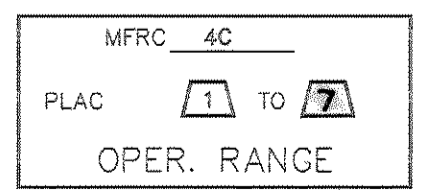

OPER	ACTION CODE	MAJOR MATERIAL DESCRIPTION	ACCT. CODE	ML OR AMT.	PL	BORE	REMOVALS
							AMOUNT
1	PLAC	MANHOLE	4C			1	
2	PLAC	TRENCH-11-MPC	4C	68'			
3	PLAC	PVC-C-4", 11	4C		748'		
4	PLAC	TRENCH-11-MPC	4C	25'			
5	PLAC	PVC-C-4", 11	4C		275'		
6	RELO	LOWER BURIED CABLE	45M			96'	
7	RELO	LOWER BURIED CABLE	45M			200'	

**CITY OF HOUSTON**  
DEPARTMENT OF PUBLIC WORKS AND ENGINEERING

REVIEWED BY  
 PRIVATELY FUNDED PUBLIC WORKS: *[Signature]*  
 CITY FUNDED PUBLIC WORKS: *[Signature]*  
 PROJECT MANAGER  
 WASTEWATER: *[Signature]* 9.11.03  
 CONSTRUCTION  
 STORM WATER: *[Signature]* 9.11.03  
 CHIEF ENGINEER  
 STREET & BRIDGE  
 OTHER APPROVAL  
 TRAFFIC AND TRANSPORTATION: *[Signature]*  
 SPONSOR DEPARTMENT  
 CITY ENGINEER: *[Signature]* 9/15/03  
 DATE  
 DIRECTOR OF PUBLIC WORKS AND ENGINEERING: *[Signature]* DATE

**PROPOSED DUCTS ALONG**  
**ALMEDA GENOA @ HWY. 288**

SCALE: PLAN 1"= 20' PROFILE VERT. 1"= 4' PROFILE HORZ. 1"= 20'

C.P.# 703-005  
 PREPARED BY: *[Signature]*  
 DRAWN BY: *[Signature]* ISSUE DATE: 10/24/03  
 PREPARED BY CONDUIT DISTRICT: *[Signature]* DRAWN: *[Signature]*  
 PROJECT NO. 5100466 REC REF ID-E2-19A SHEET NO. 103  
 AREA NO. WK4433 c.01/DLEWOOD'433 TAX DIST. HGO31

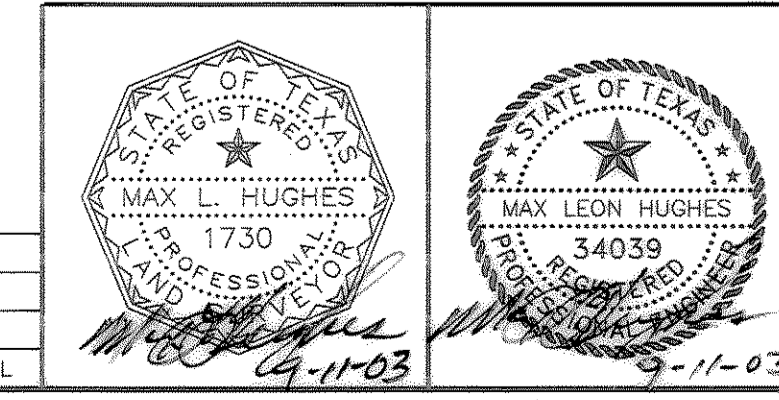

BENCH MARK:  
Top Of PK Nail, Located Between The Exit Ramp  
And Access Road Of Hwy. 288  
At @ Sta. 10+05, 69.3' Lt., Byers B  
Elev. = 55.85  
City of Houston Monument #5351-1207 Located @  
The Intersection of Almeda Genoa and Hycohen North  
Elev. = 57.07 (1973 Adjustment)

REVISION	REVISION DATE	DESCRIPTION	INITIAL