

FINAL 51

HARRIS COUNTY TOLL ROAD AUTHORITY

PLANS OF PROPOSED SAM HOUSTON TOLLWAY SOUTH IMPROVEMENTS

NET LENGTH OF PROJECT:
 ROADWAY 58,294.64 FT. - 11.040 MI. BRIDGE 0.00 FT. - 0.00 MI. TOTAL 58,294.64 FT. - 11.040 MI.

HARRIS COUNTY

SAM HOUSTON TOLLWAY-SOUTHWEST ROADWAY ILLUMINATION

FROM 0.85 MILES EAST OF US 59(S) TO SH 288

CONSISTING OF INSTALLATION OF ROADWAY ILLUMINATION

FEDERAL AID PROJECT NO. NH 96(5)
 CONTROL, SECTION, JOB NO. 3256-04-051

SW

INDEX OF SHEETS

SHEET NO.	DESCRIPTION
1	TITLE SHEET
2-3	GENERAL NOTES & SPECIFICATION DATA
4	ESTIMATE AND QUANTITIES
5-15	ILLUMINATION LAYOUT
20-26	CIRCUIT DIAGRAMS
27-29	UNDERPASS LIGHTING CONDUIT DETAILS
30	ELECTRICAL SERVICE DATA SHEET & GROUND BOX DETAILS

- STANDARD DETAIL DRAWINGS
- 31-33 * LIGHTING DETAILS - HOUSTON DISTRICT, 12-93 (3 SHEETS)
 - 34-38 * ELECTRICAL DETAILS, ED(1)-93 THRU ED(5)-93
 - 39-42 * ROADWAY ILLUMINATION DETAILS, RID(1)-93 THRU RID(4)-93
 - 43-44 * HIGH MAST ILLUMINATION POLES 100'-125'-150'-175' (HMP) (2 SHEETS)
 - 45-46 * HIGH MAST ILLUMINATION POLE FOUNDATIONS (HMIF) (2 SHEETS)
 - 47-56 * HIGH MAST ILLUMINATION DETAILS, HMD(1)-86 THRU HMD(10)-86
 - 57 * CONCRETE TRAFFIC BARRIER, TYPE 2, ROADWAY CTB AT LIGHT POLES CTB(3)-85
 - 58 * CONCRETE TRAFFIC BARRIER CTB(4)-94
 - 59 * METAL BEAM GUARD FENCE MBGF-94
 - 60-68 * BARRICADE AND CONSTRUCTION STANDARDS, BC(1)-94 THRU BC(9)-94

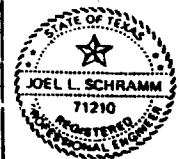
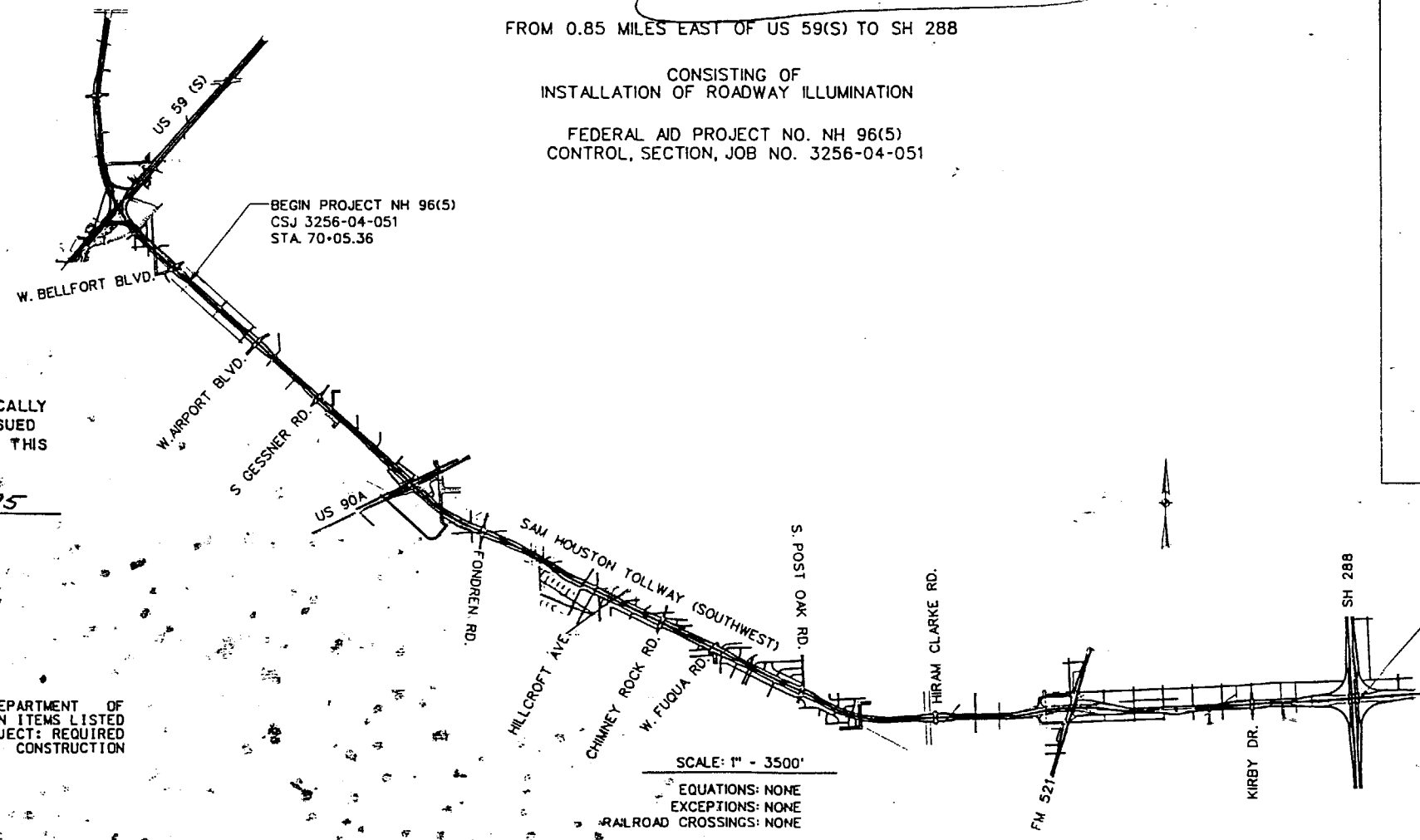
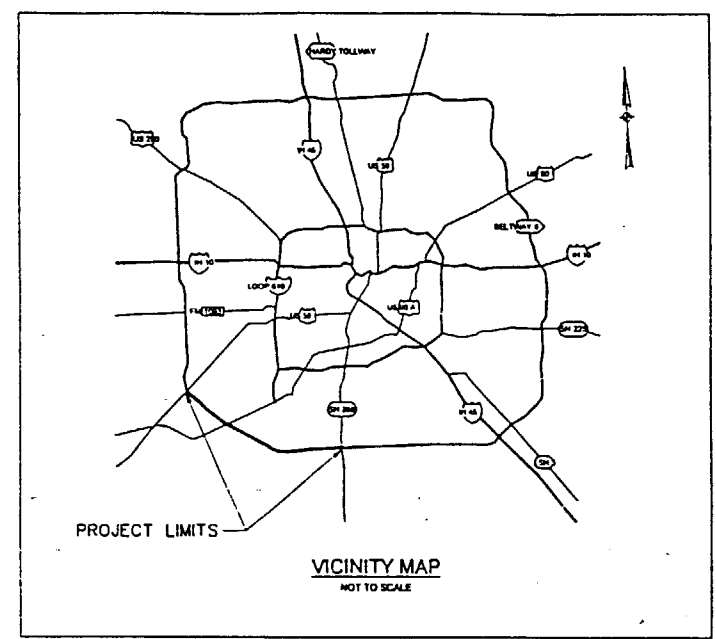

* THE STANDARD DRAWINGS SPECIFICALLY IDENTIFIED BY (*) HAVE BEEN ISSUED BY ME AND ARE APPLICABLE TO THIS PROJECT.
Joel Schramm 10-26-95

NOTE:
 SPECIFICATIONS ADOPTED BY THE TEXAS DEPARTMENT OF TRANSPORTATION, MARCH 1, 1993 AND SPECIFICATION ITEMS LISTED AND DATED AS FOLLOWS, SHALL GOVERN ON THIS PROJECT: REQUIRED CONTRACT PROVISIONS FOR ALL FEDERAL-AID, CONSTRUCTION CONTRACTS (FORM FHWA 1273, DECEMBER 1993).

SCALE: 1" = 3500'
 EQUATIONS: NONE
 EXCEPTIONS: NONE
 RAILROAD CROSSINGS: NONE

PREPARED BY:
TRAFFIC ENGINEERING & DESIGN SYSTEMS, INC.
 TEDSI
Jules M. Morris, Jr.
 JULES M. MORRIS, JR., P.E.
 PRINCIPAL
 DATE: 10/26/95

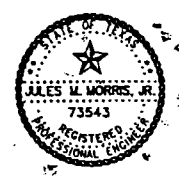

RECOMMENDED BY:
TurnerCollieBraden Inc.
Robert W. Barnett
 ROBERT W. BARNETT, P.E.
 PROJECT DIRECTOR
 DATE: 10-27-95



RECOMMENDED BY:
 HARRIS COUNTY TOLL ROAD AUTHORITY
Mike Streck
 MIKE STRECH, P.E.
 ASSISTANT DIRECTOR - SERVICES
 DATE: 10-31-95

APPROVED BY:
 HARRIS COUNTY TOLL ROAD AUTHORITY
Wesley Freise
 WESLEY FREISE, P.E.
 EXECUTIVE DIRECTOR
 DATE: 11-1-95

FED. PROJ. NO.	STATE	FEDERAL PROJECT NO.	SHEET NO.
6	TEXAS	NH 96(5)	1
STATE DIST. NO.	COUNTY	CONT. SECT.	JOB HWY. NO.
HOUSTON	HARRIS	3256 04 051	SHTW-S

LEGEND

- PROPOSED 50' SHOE BASE POLE WITH 2-8' ARMS (TY SP 50S-8-8) (.4 KW) S
- PROPOSED 50' SHOE BASE POLE WITH 1-8' ARM (TY SP 50S-8) (.4 KW) S
- PROPOSED 50' TRANSFORMER BASE POLE WITH 1-8' ARM (TY SA 50T-8) (.4 KW) S
- ▶ PROPOSED UNDERPASS LIGHT FIXTURE (TY SPL-CO) (.15KW) S (TY3)
- PROPOSED 150' HIGH MAST POLE (12-400 WATT ASYMMETRIC FIXTURES)
- PROPOSED GROUND BOX
- EXISTING GROUND BOX
- ⊙ PROPOSED TYPE A SERVICE POLE
- EXISTING 2" SCH 80 PVC CONDUIT
- PROPOSED 2" SCH 80 PVC CONDUIT
- PROPOSED 3/4" RIGID METAL CONDUIT
- PROPOSED SCH 80 PVC CONDUIT (BORED)

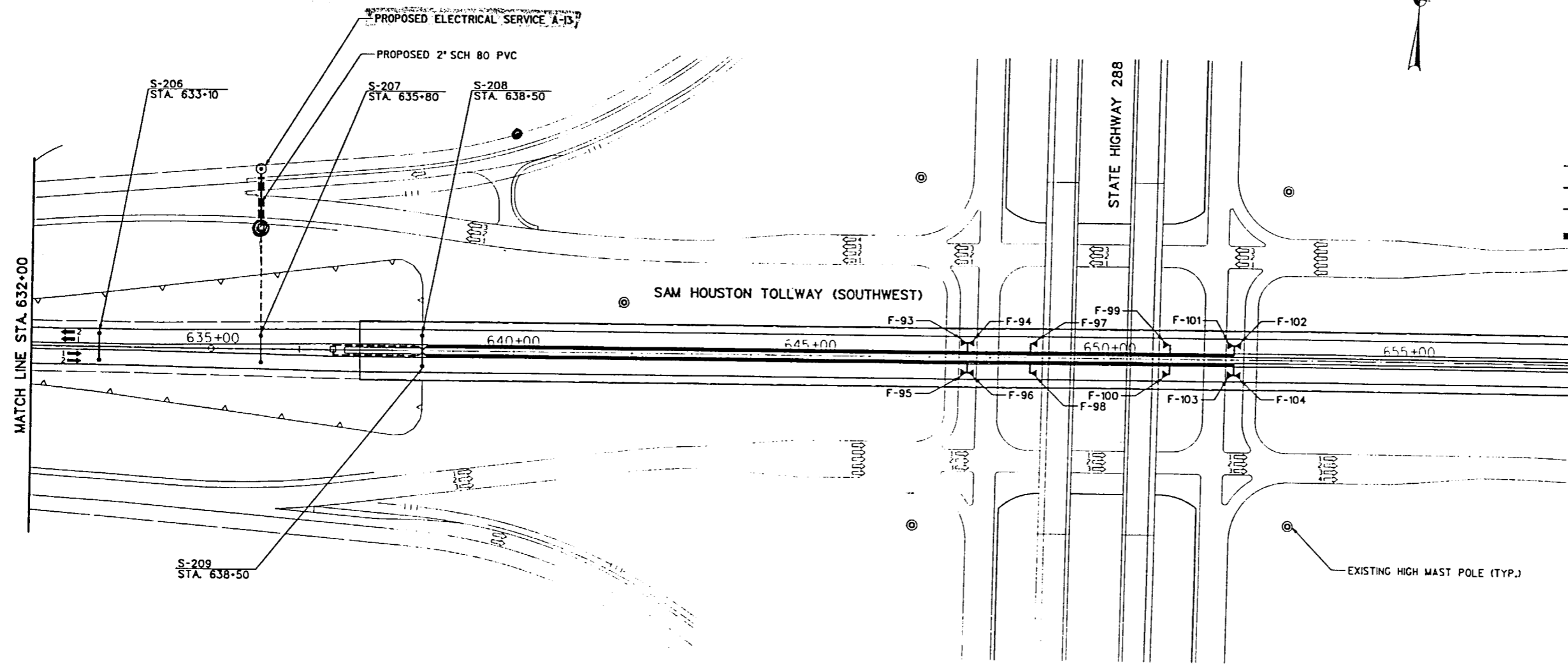

LIGHT STANDARD & UNDERPASS LIGHT FIXTURE SCHEDULE

FIXT. NO.	STATION	LOCATION	WATT	TYPE	STANDARD TYPE
S-206	633+10	MEDIAN CONCRETE TRAFFIC BARRIER	2-400	HPS	TY SP 50S-8-8 (.4 KW) S
S-207	635+80	MEDIAN CONCRETE TRAFFIC BARRIER	2-400	HPS	TY SP 50S-8-8 (.4 KW) S
S-208	638+50	MEDIAN CONCRETE TRAFFIC BARRIER	1-400	HPS	TY SP 50S-8 (.4 KW) S
S-209	638+50	MEDIAN CONCRETE TRAFFIC BARRIER	1-400	HPS	TY SP 50S-8 (.4 KW) S
F-93	647+62	BENT *11 FOR U-TURN	2-400	HPS	TY SPL-CO (.15KW) S (TY3)
F-94	647+62	BENT *11 FOR THRU LANES	2-400	HPS	TY SPL-CO (.15KW) S (TY3)
F-95	647+62	BENT *11 FOR U-TURN	2-400	HPS	TY SPL-CO (.15KW) S (TY3)
F-96	647+62	BENT *11 FOR THRU LANES	2-400	HPS	TY SPL-CO (.15KW) S (TY3)
F-97	648+68	BENT *12 FOR THRU LANES	2-400	HPS	TY SPL-CO (.15KW) S (TY3)
F-98	648+68	BENT *12 FOR THRU LANES	2-400	HPS	TY SPL-CO (.15KW) S (TY3)
F-99	650+98	BENT *14 FOR THRU LANES	2-400	HPS	TY SPL-CO (.15KW) S (TY3)
F-100	650+98	BENT *14 FOR THRU LANES	2-400	HPS	TY SPL-CO (.15KW) S (TY3)
F-101	652+04	BENT *15 FOR THRU LANES	1-150	HPS	TY SPL-CO (.15KW) S (TY3)
F-102	652+04	BENT *15 FOR U-TURN	1-150	HPS	TY SPL-CO (.15KW) S (TY3)
F-103	652+04	BENT *15 FOR THRU LANES	1-150	HPS	TY SPL-CO (.15KW) S (TY3)
F-104	652+04	BENT *15 FOR U-TURN	1-150	HPS	TY SPL-CO (.15KW) S (TY3)

ESTIMATED QUANTITIES

ITEM NO.	DESC. CODE	SP	DESCRIPTION	UNIT	SHEET TOTAL
610	513		RDWY ILL ASSEM (TY SP 50S-8) (.4 KW) S	EA	2
610	514		RDWY ILL ASSEM (TY SP 50S-8-8) (.4 KW) S	EA	2
610	519		RDWY ILL AM U/P (TY SPL-CO) (.15KW) S (TY3)	EA	12
618	501		CONDUIT (RM) (3/4")	LF	3150
618	518		CONDUIT (PVC) (SCHD 80) (2")	LF	30
618	539		CONDUIT (PVC) (SCHD 80) (2") (BORED)	LF	60
620	501		ELEC CONDUCTOR (NO. 12) BARE	LF	440
620	503		ELEC CONDUCTOR (NO. 8) BARE	LF	4570
620	507		ELEC CONDUCTOR (NO. 12) INSULATED	LF	880
620	510		ELEC CONDUCTOR (NO. 6) INSULATED	LF	9140
62B	543		ELEC SERV TYA (240/480) 060 (SS) SS (E) SP (U)	EA	1

SHEET TOTALS

EST.	FINAL	UNIT	DESCRIPTION

NO.	DATE	REVISION	APP

10/27/15

**SAM HOUSTON TOLLWAY
SOUTHWEST**

**ILLUMINATION LAYOUT
STA. 632+00 TO END JOB**

SCALE: 1" = 100'		SHEET 15 OF 15	
STATE	COUNTY	FEDERAL PROJECT NO.	SHEET NO.
6	TEXAS	NH 96(5)	19
STATE DIST NO.	COUNTY	CONI SECT.	JOB HWY NO.
HOUSTON	HARRIS	3256 04	051 SHTW-5