

HARRIS COUNTY - TEXAS

BENTON H. FREELING A-270

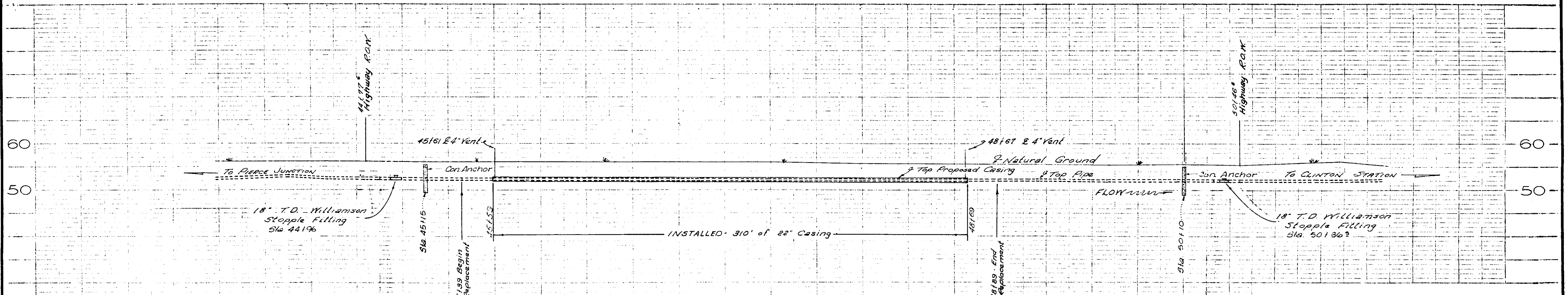
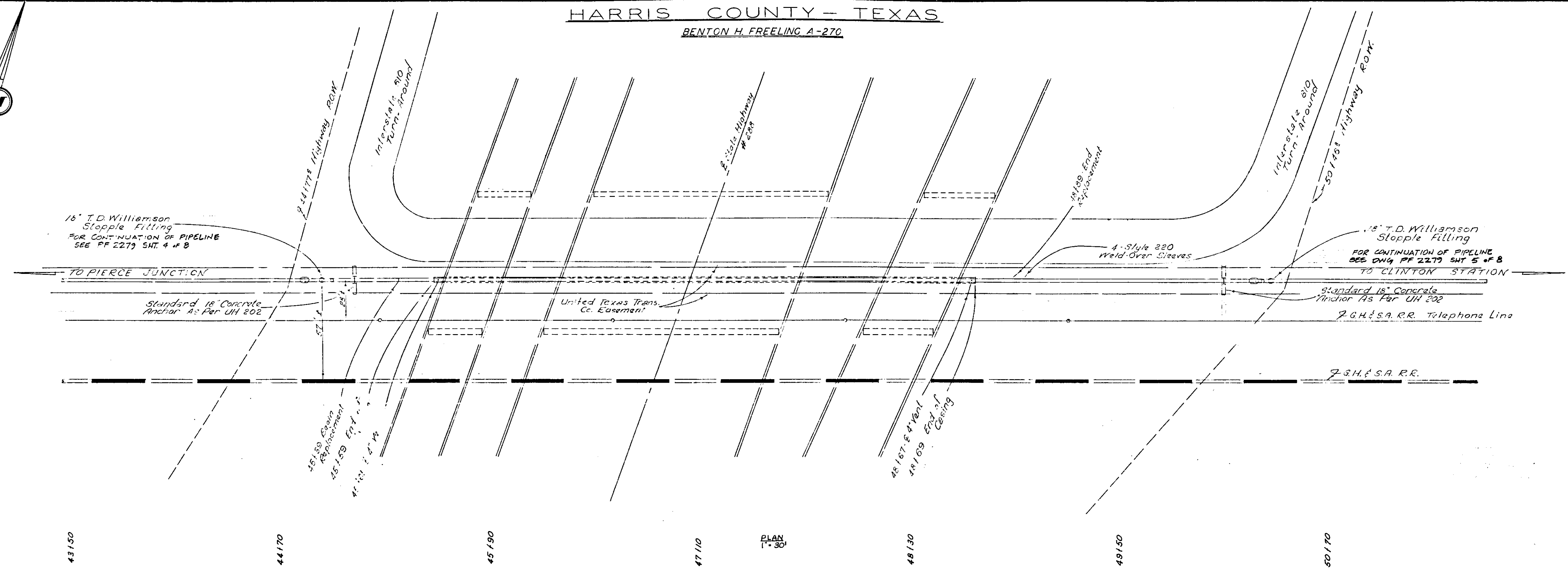

PROFILE
1" = 30' HORIZ.
1" = 10' VERT.

4 1/2" I.D. 18" O.D. PIPE STA. 37417 TO STA. 50136 PER 72822

UNITED TEXAS TRANSMISSION COMPANY ENGINEERING DEPARTMENT - HOUSTON, TEXAS			
ADJUST PIERCE JUNCTION-CLINTON 18" LINE FOR CONSTRUCTION OF STATE HIGHWAY 288 HARRIS COUNTY-TEXAS			
SURVEYED BY	DATE	CORRECT BY	DATE
DRAWN BY Sawyer	DATE 7-22-70	APPROVED BY	DATE
TRACED BY	DATE	APPR. BY	DATE
CHECKED BY	DATE		
E. R. No.	SCALE Noted	PF 1006	
W. A. No.	SHEET 1 OF 1	INDEX 56	

24 X REDUCTION
6" - FULL SCALE