

Proposed Restricted Crossing U-turn (RCUT)

An innovative intersection design proposed to improve safety and mobility on US 183

TxDOT is developing plans to improve US 183 at Riverside Drive in Travis County. A restricted crossing U-turns (RCUTs) is proposed at the Riverside Drive intersection. The anticipated construction start date will be in early 2025.

Why is TxDOT proposing this design?

A restricted crossing U-turn is an innovative intersection design to improve safety. Turning movements for drivers entering or crossing US 183 are modified to reduce the number and type of conflict points. The RCUT intersection reduces the number of conflict points that lead to right-angle crashes.

How would it work?

Drivers on Riverside Drive would now turn right onto US 183 and use a new strategically placed U- turn to continue their movement through to the local street or left onto US 183. Although the travel distance for local street traffic increases, overall travel times decrease due to improved operations.

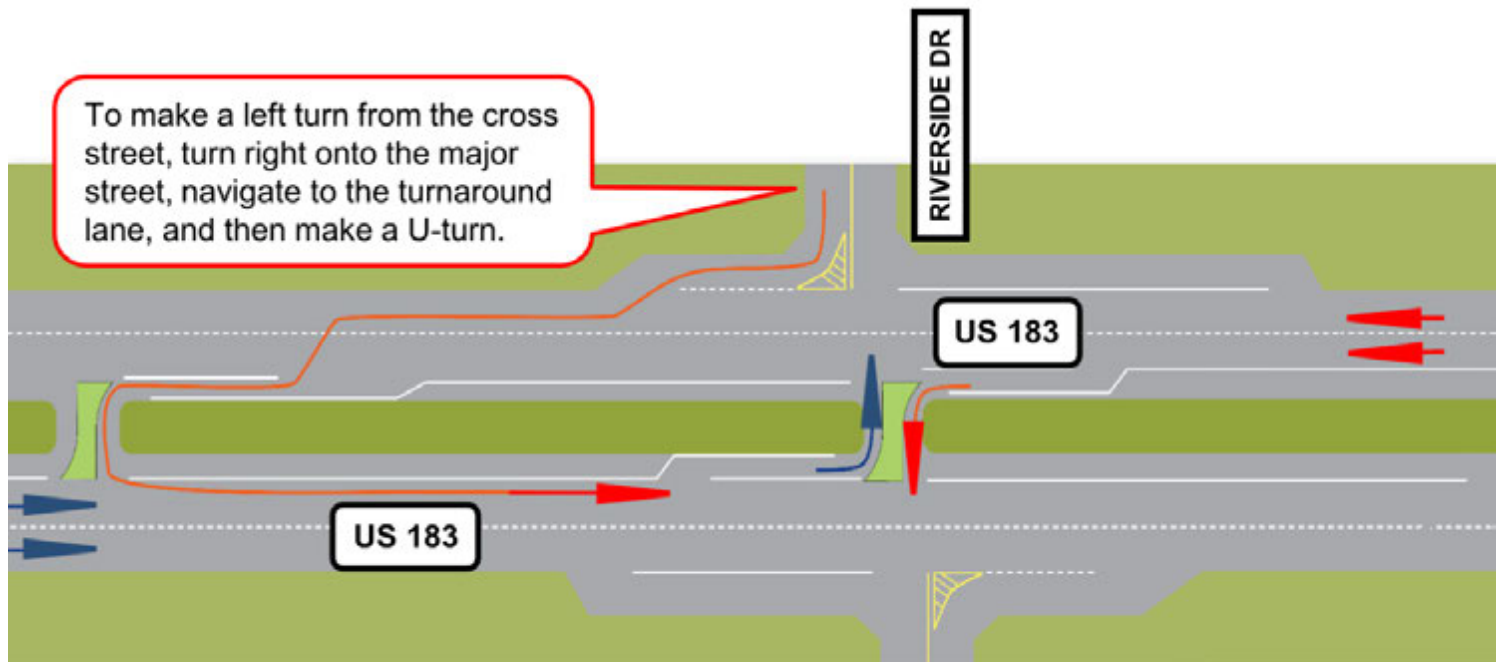

***Not to scale:**

Distances will be based on roadway design standards and will allow for appropriate maneuverability

Contact Information:

Austin District Office

Solomon Bekele: (512) 832-7374

7901 N I-35 Austin, TX 78753