

**ASPHALT IN-HOUSE CALIBRATION PROCEDURE # 11 C**  
**APPARATUS FOR SOFTENING POINT TEST OF BITUMEN (RING)**

**EQUIPMENT CHECKED: APPARATUS FOR SOFTENING POINT TEST OF BITUMEN (Ring) (AASHTO T 53) (ASTM D 36)**

**1. SCOPE**

1.1 This procedure provides instructions for checking the equipment used to perform the softening point test.

**2. APPARATUS**

*Inspection Equipment Required:*

1. Caliper, readable to 0.001 in.
2. Metal ruler, readable to 1.0 mm

*Tolerance:*

Equipment shall meet the tolerances specified in test methods T 53 and D 36.

**3. PROCEDURE**

- 3.1 Viewing the illustration in test method T 53 or D36, use a caliper, readable to 0.01 inches, to measure the outer diameter at the top of the shoulder. Record measurement.
- 3.2 Measure and record the inner diameter at the top of the shoulder.
- 3.3 Measure and record the outer diameter at the bottom the ring.
- 3.4 Measure and record the inner diameter at the bottom of the ring.
- 3.5 Measure and record the total height of the ring.

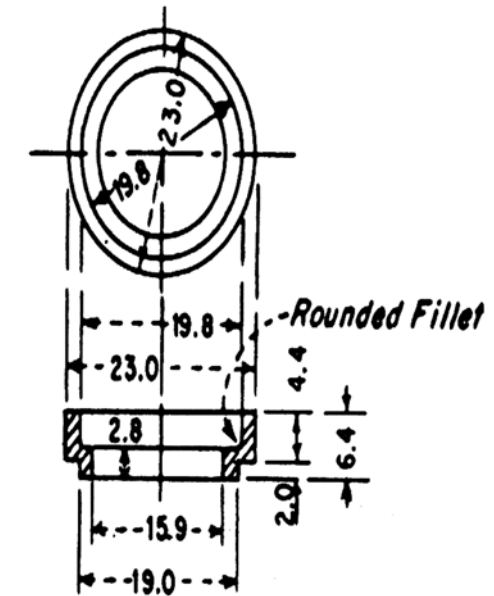

**(a) Shouldered Ring**