

**ASPHALT IN-HOUSE CALIBRATION PROCEDURE # 8  
CUP FOR CLEVELAND OPEN CUP FLASH**

**EQUIPMENT CHECKED: CUP FOR CLEVELAND OPEN CUP FLASH (AASHTO T 48)  
(ASTM D 92)**

---

**1. SCOPE**

1.1 This procedure gives instructions for checking critical dimensions of a Cleveland flash cup.

---

**2. APPARATUS**

*Inspection Equipment Required:*

Caliper, readable to 0.001 in.

*Tolerance:*

Equipment shall meet the tolerances specified in test methods T 48 and D 92.

---

**3. PROCEDURE**

3.1 Viewing the illustration in test method T 48 or D 92, use a caliper, readable to 0.001 inches, to measure the following dimensions:

3.1.1 Measure and record outer diameter of flange.

3.1.2 Measure and record outer diameter below flange.

3.1.3 Measure and record inner diameter.

3.1.4 Measure and record depth of cup.

3.1.5 Measure and record rim to fill mark.

3.1.6 Measure and record thickness of bottom.

ASPHALT IN-HOUSE CALIBRATION PROCEDURE # 8  
CUP FOR CLEVELAND OPEN CUP FLASH

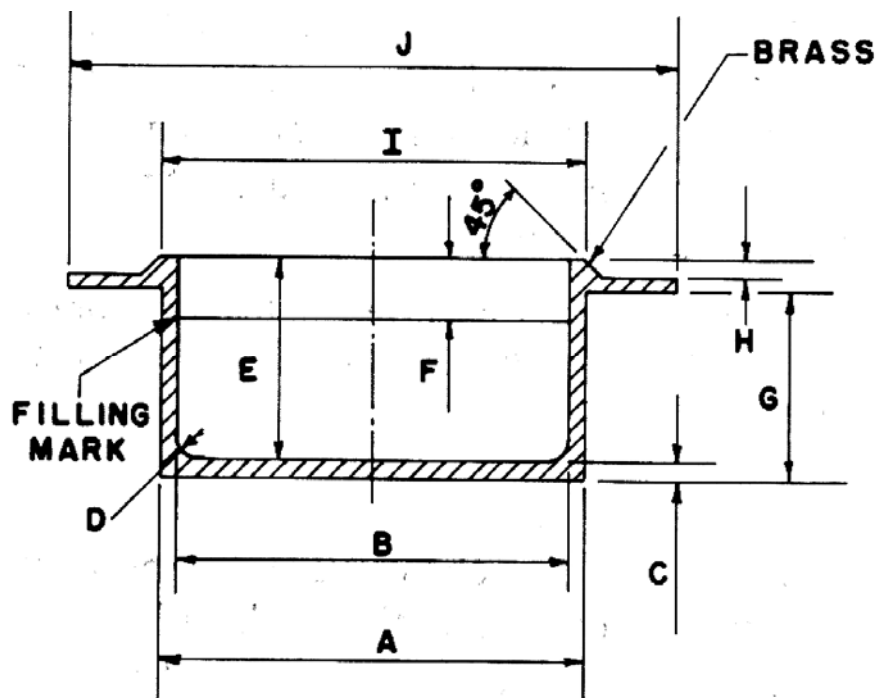

	millimetres	
	min	max
A	67.5	69
B	63	64
C	2.8	3.5
D—Radius	4	nominal
E	32.5	34
F	9	10
G	31	32.5
H	2.8	3.5
I	67	70
J	97	100